



Post Office Department,

OFFICE OF THE FIRST ASSISTANT P. M. GENERAL,

WASHINGTON, D. C., *Nov. 25*, 1887.

Sir: Before the Postmaster General decides upon the application for the establishment of a post office at _____, County of *Boone*, State of *Kentucky*, it will be necessary for you to carefully answer the subjoined questions, get a neighboring postmaster to certify to the correctness of the answers, and return the location paper to the Department, addressed to me. If the site selected for the proposed office should not be on any mail route now under contract, only a "Special Office" can be established there, to be supplied with mail from some convenient point on the nearest mail route by a special carrier, for which service a sum equal to two-thirds of the amount of the salary of the postmaster at such office will be paid.

You should inform the contractor, or person performing service for him, of this application, and require him to execute the inclosed certificate as to the practicability of supplying the proposed office with mail, and return the same to the Department.

Very respectfully,

A. E. Stevenson
First Assistant Postmaster General.

To Mr. *J. Pugh*,
care of the Postmaster of *Washington*, who will please forward to him.

STATEMENT. *Ch. na to Devon*

The proposed office to be called

Crescent Valley Boone Co Ky

Select a short name for the proposed office, which, when written, will not resemble the name of any other post office in the State.

It will be situated in the _____ quarter of Section _____, Township _____ (North or South), Range _____ (East or West), _____ in the County of *Boone*, State of *Kentucky*

It will be on or near route No. _____, being the route from *Lawrence* to *Chalona*, on which the mail is now carried _____ times per week.

The contractor's name is *C. S. C. & T. K. Railway*

Will it be directly on this route?—*Yes*

If not, how far from, and on which side of it?—*None*

How much will it INCREASE the travel of the mail one way each trip?—*None*

Where will the mail leave the present route to supply the proposed office?—*Not done at all*

Where intersect the routes again?—*from Post Master to Mail agh*

What post office will be left out by this change?—*None*

If not on any route, is a "Special Office" wanted?—*Yes*. To be supplied from _____

The name of the nearest office to the proposed one, on the same route, is *Richwood Boone Co*

its distance is *three (3)* miles in a *Southern* direction from the proposed office.

The name of the nearest office on the same route, on the other side, is *Exchange Kentucky*

its distance is *four (4)* miles in a *Northern* direction from the proposed office.

The name of the nearest office to the proposed one, not on this route, is *Lawrence Boone Co*

distance by the most direct road *2 3/4* miles in a *N. W.* direction from the proposed office.

The name of the most prominent river near it is *Whig*

The name of the nearest creek is *Banklick*

The proposed office will be *1 1/2* miles from said river, on the *South* side of it, and will be *3* miles from said nearest creek, on the *West* side of it

The name of the nearest railroad is *C. W. C. & T. P. Rop. (Cincinnati Southern Ry)*

If on the line of or near a railroad, on which side will the office be located; how far from the track; and what is, or will be, the name of the station?—*On East side adjacent to track*

What will be the distance from the proposed site to the nearest flag station?—*Not such established station*

State name of station: *Station is now used but Railroad propose to change*

What will be the distance from the proposed site to the nearest station at which mail trains make regular stops?—*3 1/2 Miles*

State name of station: *Richwood Ky. Exchange Ky.*

If the proposed office is located where it can be supplied from a crane or flag station, or located over 50 rods from the station where mail trains pass, can an established _____ be built _____ or _____

If it be a village, state the number of inhabitants—*It is the beginning of a settlement*

Also, the population to be supplied by the proposed office—*150 or 200*

A diagram, or sketch from a map, showing the position of the proposed new office, with neighboring river or creek, roads, and other post offices, towns, or villages near it, will be useful, and is therefore desired.

A correct map of the locality might be furnished by the county surveyor, but this must be without expense to the Post Office Department.

ALL WHICH I CERTIFY to be correct and true, according to the best of my knowledge and belief, this _____ day of _____, 188 _____

(Sign full name.)

Jules M. W., Proposed P. M.

I CERTIFY that I have examined the foregoing statement, and that it is correct and true to the best of my knowledge and belief.

J. D. Stephens
Postmaster at *Richwood Boone Co Ky*

(OVER.)

Be careful to answer the inquiries fully and accurately, or the case will not be acted upon.

Diagram showing the site of the _____ Post Office
 in Township _____ (N. or S.), Range _____ (E. or W.) of _____ Principal
 Meridian, County of _____ State
 of _____, with the adjacent Townships and Post Offices.



It is requested that the exact site of the proposed or existing Post Office, and the roads to the adjoining offices, and the larger streams or rivers, be marked on this diagram, to be returned as soon as possible to the Post Office Department.

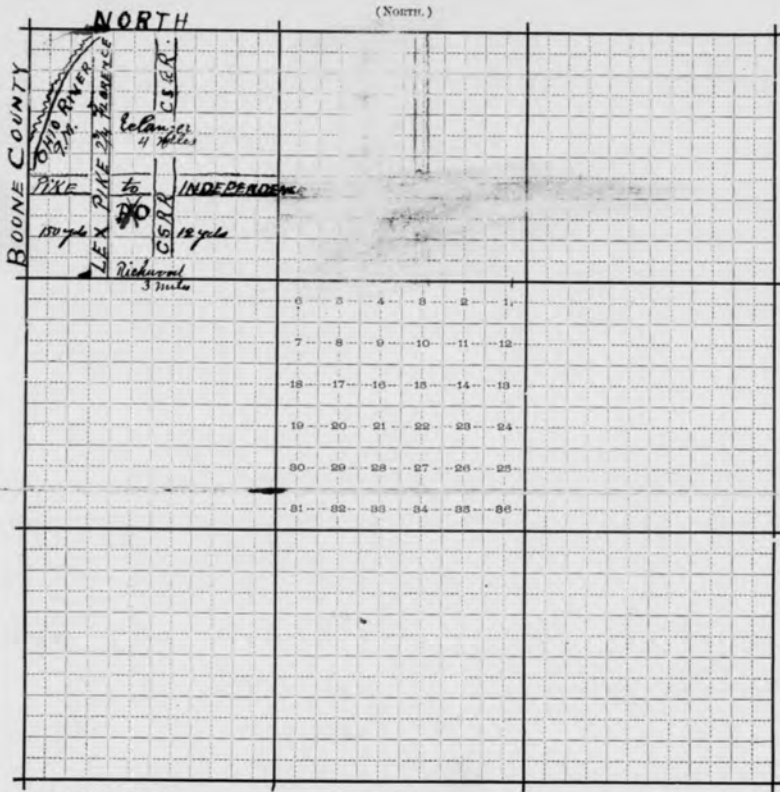

R.W.

D.

POST OFFICE DEPARTMENT
OFFICE OF THE
FOURTH ASSISTANT POSTMASTER GENERAL
WASHINGTON

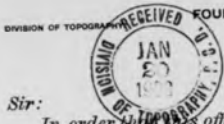

Jan. 9/08

Sir:

In order that the Post Office may determine, with as much accuracy as possible, the relative positions of Post Offices, so that they may be correctly delineated on its maps, please carefully answer the questions below, and furnish the diagram on the other side, returning the same as soon as possible, verified by your signature and dated.

Very respectfully,

C. H. D. Row

Fourth Assistant Postmaster General.

TO POSTMASTER AT *Devon, late Crescent.*
Boone Co.,

Ky.

The (P. O. Dept.) name of my Office is *Devon*

If the town, village, or site of the Post Office be known by another name than that of the Post Office, state that other name here: *Dixon*

My Office is situated in _____ part of _____ Township, or in _____ quarter of Tract

No. _____ Township, County of *Boone*

State of *Ky.*

The name of the most prominent river near it is *Ohio*

The name of the nearest creek is *Banklick*

My Office is *1.0* miles from said river, on the *South* side of it, and is *about 2 1/2* miles from said nearest creek, on the *west* side of it.

My Office is on Mail Route No. *none*

My Office is a Special Office supplied from *none* miles distant.

The name of the nearest Office on my route is *none*, and its distance is _____ miles, by the traveled road, in a _____ direction from this, my Office.

The name of the nearest Office, on the same route, on the other side, is *none* and its distance is _____ miles in a _____ direction from this, my Office.

The name of the nearest Office off the route is _____, and its distance by the most direct road is _____ miles in a _____ direction from this, my Office.

My Office is at a distance of *24 9/16* from the track of the *C.N. O. and T. P.* Railroad, on the *west* side of the railroad.

My Office is _____ miles, air-line distance, from nearest point of my County boundary.

(Signature of Postmaster) *H. P. Dixon*

(Date) *Jan 17th*

DIAGRAM, EXPLANATION, AND INSTRUCTIONS.

The dot in the center of the 1-mile circle represents the site of your office.

The surrounding offices should be carefully located by placing dots on or between the mile circles at the exact distance, and in the right direction from your office, and their names plainly written.

If it should be necessary to designate an office which is over 10 miles from your site, place the dot outside of the 10-mile circle, write the name of such office, and state its distance from your site.

Draw distinctly the railways, roads, rivers, and creeks.

