



# Post Office Department,

OFFICE OF THE FIRST ASSISTANT P. M. GENERAL,

WASHINGTON, D. C., 19 Jan, 1882

Sir: Before the Postmaster General decides upon the application for a new post office at Hammarville, County of Rockwell, State of Kentucky at which you are recommended for postmaster, he requires that the blanks in the following statement be filled, and the questions carefully and correctly answered, verified by your signature, certified by a neighboring postmaster, and returned to this Department, addressed to me. The contractor should be informed of this application; and if the site of the proposed office be off the mail route, you will forward his certificate as to the practicability of supplying it, and also as to the increase of distance. If the proposed office is not on any route now under contract, it can only be established as a "Special Office," to be supplied without expense to the Department other than net proceeds.

Be careful to designate the post offices by their true official names; and answer the subjoined queries fully and accurately, or the case will not be acted upon.

Very respectfully,

FRANK HATTON,  
First Assistant Postmaster General.

To Mr. J. W. Kennedy  
care of the Postmaster of Hamilton, who will please forward to him.

### STATEMENT.

The proposed office to be called Hammarville Landing

Select a short name for the proposed office, which, when written, will not resemble the name of any other post office in the United States.

It will be situated in the 30 quarter of Section \_\_\_\_\_, Township \_\_\_\_\_ (North or South), North  
 Range East (East or West), \_\_\_\_\_ in the County of Boone, State of Kentucky  
 It will be on or near route No. 20106 being the route from Hamilton  
 to Walton, on which the mail is now carried twice times per week.  
 The contractor's name is Al. Moore, Jr., Lytton & G. St. Chambers  
 Will it be directly on this route?—Ans. Yes  
 If not, how far from, and on which side of it?—Ans. None  
 How much will it INCREASE the travel of the mail one way each trip?—Ans. None  
 Where will the mail leave the present route to supply the proposed office?—Ans. None  
 Where intersect the route again?—Ans. None  
 What post office will be left out by this change?—Ans. None  
 If not on any route, is a "Special Office" wanted?—Ans. To be supplied from  
 The name of the nearest office to the proposed one, on the same route, is Hamilton  
 its distance is one & one eighth miles in a South west direction from the proposed office.  
 The name of the nearest office on the same route, on the other side, is Bowen  
 its distance is five miles, in a East direction from the proposed office.  
 The name of the nearest office to the proposed one, not on this route, is Champion  
 its distance by the most direct road five miles, in a West direction from the proposed office.  
 The name of the most prominent river near it is Ohio  
 The name of the nearest creek is Landing  
 The proposed office will be one & 1/2 miles from said river, on the East side of it, and will be one & 1/2 miles from said nearest creek, on the East side of it.  
 The name of the nearest railroad is Lex. & C. Short line  
 If on the line of or near a railroad, on which side will the office be located; how far from the track; and what is, or will be, the name of the station?—Ans. \_\_\_\_\_  
 What will be the distance from the proposed site to the nearest any station?—Ans. \_\_\_\_\_  
 State name of station: \_\_\_\_\_  
 What will be the distance from the proposed site to the nearest station at which mail trains make regular stops?—Ans. \_\_\_\_\_  
 State name of station? \_\_\_\_\_  
 If the proposed office is located where it can be supplied from a crane or flag station, or located over 50 rods from the station where mail trains make regular stops, will the mail be carried to and from the proposed office without expense to the Department?—Ans. \_\_\_\_\_  
 If it be a village, state the number of inhabitants.—Ans. 72  
 Also, the population to be supplied by proposed office.—Ans. 500  
 A diagram, or sketch from a map, showing the position of the proposed new office, with neighboring river or creek, roads, and other post offices, towns, or villages near it, will be useful, and is therefore desired.  
 A correct map of the locality might be furnished by the county surveyor, but this must be without expense to the Post Office Department.  
 ALL WHICH I CERTIFY to be correct and true, according to the best of my knowledge and belief, this 17th day of Feb 1882  
J. W. Kennedy (Sign full name.) Proposed P. M.

I CERTIFY that I have examined the foregoing statement, and that it is correct and true, to the best of my knowledge and belief.

Postmaster at J. A. Sleet

(OVER.)



*San Francisco*  
*San Francisco*  
*March 22*

**Diagram** showing the site of the \_\_\_\_\_ Post Office  
in Township \_\_\_\_\_ (N. or S.), Range \_\_\_\_\_ (E. or W.) of \_\_\_\_\_ Principal  
Meridian, County of \_\_\_\_\_, State  
of \_\_\_\_\_, with the adjacent Townships and Post Offices.

It is requested that the exact site of the proposed or existing Post Office, as also the roads to the adjoining offices, and the larger streams or rivers, be marked on this diagram, to be returned as soon as possible to the Post Office Department.

( NORTH. )

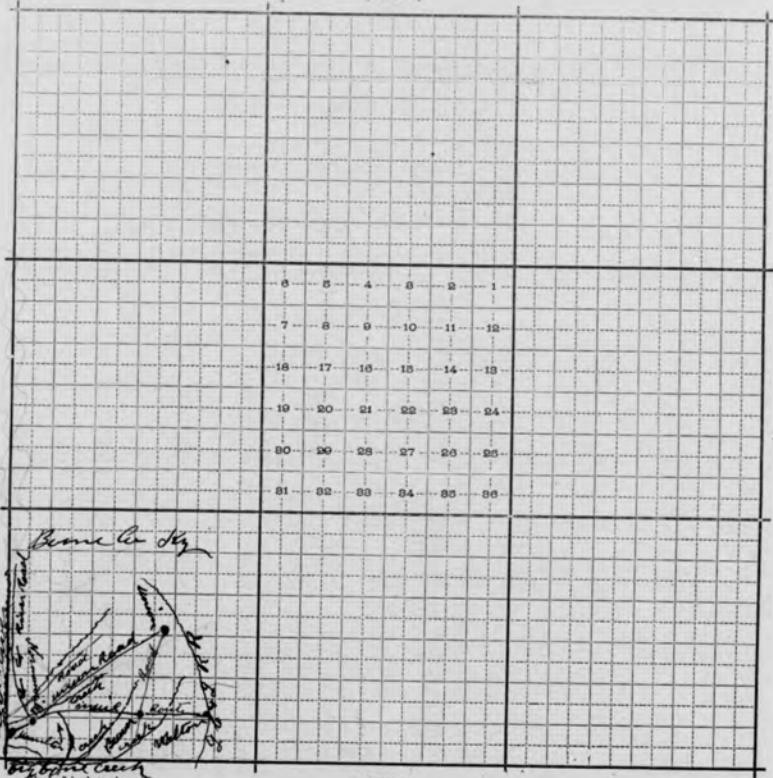

( SOUTH. )

yes

**Post Office Department,**  
OFFICE OF THE FOURTH ASSISTANT POSTMASTER GENERAL,  
APPOINTMENT DIVISION.

WASHINGTON, D. C., MAY 20 1901, 1901

Sir: Before the Postmaster General decides upon the application for the establishment of a post office at Landing, County of Bourne, State of Ky., it will be necessary for you to carefully answer the subjoined questions, get a neighboring postmaster to certify to the correctness of the answers, and return the location paper to the Department, addressed to me. If the site selected for the proposed office be not on any mail route, only a "Special Office" can be established, to be supplied with mail from some convenient point on the nearest mail route by a special carrier, for which service a sum equal two-thirds the salary of the postmaster will be paid by the Department.

You should inform the contractor, or person performing service for him, of this application, and require him to execute the appended certificate as to the practicability of supplying the proposed office with mail.

Very respectfully,

*J. P. Bristow*

Fourth Assistant Postmaster General.

To Mr. John C. Miller  
care of the Postmaster of Big Bone, who will please forward to him.

STATEMENT.

The proposed office to be called Landing Ky.

**Notice directions for selecting post office names on next page.**

It will be situated in the \_\_\_\_\_ quarter of Section \_\_\_\_\_ Township \_\_\_\_\_ (North or South), Range \_\_\_\_\_ (East or West), \_\_\_\_\_ in the County of Bourne State of Kentucky. It will be on or near route No. \_\_\_\_\_ being the route from Walton Ky. to Hamilton Ky. on which the mail is now carried six times per week. Will it be directly on this route?—Ans. yes. If not, how much would its supply on this route increase the distance necessarily traveled by the carrier in going once over the route?

If not on any route, is a "Special Office" wanted?—Ans. \_\_\_\_\_ To be supplied from \_\_\_\_\_ The name of the nearest office to the proposed one, on one side, is Hamilton Ky. its distance is 1 1/2 miles in a south west direction from the proposed office. The name of the nearest office, on the other side, is Big Bone Ky. its distance is 1 1/2 miles in a east direction from the proposed office. The name of the other nearest office to the proposed one is Hathaway Ky. its distance by the most direct road is 4 miles in a north direction from the proposed office. The name of the most prominent river near it is Ohio River. The name of the nearest creek is Landing Creek. The proposed office will be 1 1/2 miles from said river, on the south side of it, and will be 100 yds miles from said nearest creek, on the south side of it. The name of the nearest railroad is Cincinnati Southern & Louisville Nashville. If on the line of or near a railroad, on which side will the office be located; how far from the track; and what is, or will be, the name of the station?—Ans. \_\_\_\_\_

Give the population to be supplied by the proposed office.—Ans. 164 (42 families). If it be a village, state the number of inhabitants.—Ans. 32. A diagram, or sketch from a map, showing the position of the proposed new office, with neighboring river or creek, roads, and other post offices, towns, or villages near it, will be useful, and is therefore desired. ALL WHICH I CERTIFY to be correct and true, according to the best of my knowledge and belief, this 21<sup>st</sup> day of May 1901.

( Sign full name.) John C. Miller, Proposer P. M.

I CERTIFY that I have examined the foregoing statement, and that it is correct and true, to the best of my knowledge and belief. (This must be signed by Postmaster at nearest office.)

Postmaster at

*J. C. Griffith*  
Big Bone Ky.

(OVER.)

Applications for post offices should be accompanied by petitions of the citizens interested.