



Post Office Department,

OFFICE OF THE FIRST ASSISTANT P. M. GENERAL,

WASHINGTON, D. C., 20 Nov, 1884

Before the Postmaster General decides upon the application for the establishment of a post office at Bonne, County of Bonne, State of Kentucky, it will be necessary for you to carefully answer the subjoined questions, get a neighboring postmaster to certify to the correctness of the answers, and return the location paper to the Department, addressed to me. If the site selected for the proposed office should not be on any mail route now under contract, only a "Special Office" can be established there, to be supplied with mail from some convenient point on the nearest mail route by a special carrier, for which service a sum equal to two-thirds of the amount of the salary of the postmaster at such office will be paid.

You should inform the contractor, or person performing service for him, of this application, and require him to execute the inclosed certificate as to the practicability of supplying the proposed office with mail, and return the same to the Department.

Very respectfully,

FRANK HATTON,
First Assistant Postmaster General.

To Mr. S. J. Rouse
care of the Postmaster of Burlington, who will please forward to him.

STATEMENT.

The proposed office to be called

X Limaburgh.

Select a short name for the proposed office, which, when written, will not resemble the name of any other post office in the United States.

It will be situated in the _____ quarter of Section _____, Township _____, State of _____ (North or South).
 Range _____ (East or West), _____ in the County of Bonne, State of Kentucky.
 It will be on _____ route No. 20167, being the route from Erlanger to Burlington, on which the mail is now carried 12 times per week.
 The contractor's name is E. W. Perkins.
 Will it be directly on this route?—Ans. yes.
 If not, how far from, and on which side of it?—Ans. _____
 How much will it INCREASE the travel of the mail one way each trip?—Ans. _____
 Where will the mail leave the present route to supply the proposed office?—Ans. _____
 Where intersect the route again?—Ans. _____
 What post office will be left out by this change?—Ans. none.
 If not on any route, is a "Special Office" wanted?—Ans. _____ To be supplied from _____
 The name of the nearest office to the proposed one, on the same route, is Burlington _____ miles in a West direction from the proposed office.
 The name of the nearest office on the same route, on the other side, is Fleming _____ miles in a _____ direction from the proposed office.
 The name of the nearest office to the proposed one, not on this route, is Helburn _____ miles in a North direction from the proposed office.
 The name of the most prominent river near it is Ohio.
 The name of the nearest creek is Gunsunder.
 The proposed office will be _____ miles from said river, on the _____ side of it, and will be _____ miles from said nearest creek, on the _____ side of it.
 The name of the nearest railroad is NOT.
 If on the line of or near a railroad, on which side will the office be located; how far from the track; and what is, or will be, the name of the station?—Ans. _____
 What will be the distance from the proposed site to the nearest flag station?—Ans. _____
 State name of station: _____
 What will be the distance from the proposed site to the nearest station at which mail trains make regular stops?—Ans. 6 mls.
 State name of station? Erlanger.
 If the proposed office is located where it can be supplied from a crane or flag station, or located over 80 rods from the station where mail trains make regular stops, will the mail be carried to and from the proposed office without expense to the Department?—Ans. _____

If it be a village, state the number of inhabitants.—Ans. _____

Also, the population to be supplied by the proposed office.—Ans. 200

A diagram, or sketch from a map, showing the position of the proposed new office, with neighboring river or creek, roads, and other post offices, towns, or villages near it, will be useful, and is therefore desired.

A correct map of the locality might be furnished by the county surveyor, but this must be without expense to the Post Office Department.

ALL WHICH I CERTIFY to be correct and true, according to the best of my knowledge and belief, this 27th day of

Dec, 1884 (or Sign full name.) S. J. Rouse, Proposed P. M.

I CERTIFY that I have examined the foregoing statement, and that it is correct and true, to the best of my knowledge and belief.

Dudley Rouse
Postmaster at Burlington

(OVER.)

Be careful to answer the inquiries fully and accurately, or the case will not be acted upon.

Diagram showing the site of the *Lima* Post Office
 in Township _____ (N. or S.), Range _____ (E. or W.) of _____ Principal
 Meridian, County of *Boone*, State
 of *Kentucky*, with the adjacent Townships and Post Offices.

It is requested that the exact site of the proposed or existing Post Office, as also the roads to the adjoining offices, and the larger streams or rivers, be marked on this diagram, to be returned as soon as possible to the Post Office Department.

(NORTH)

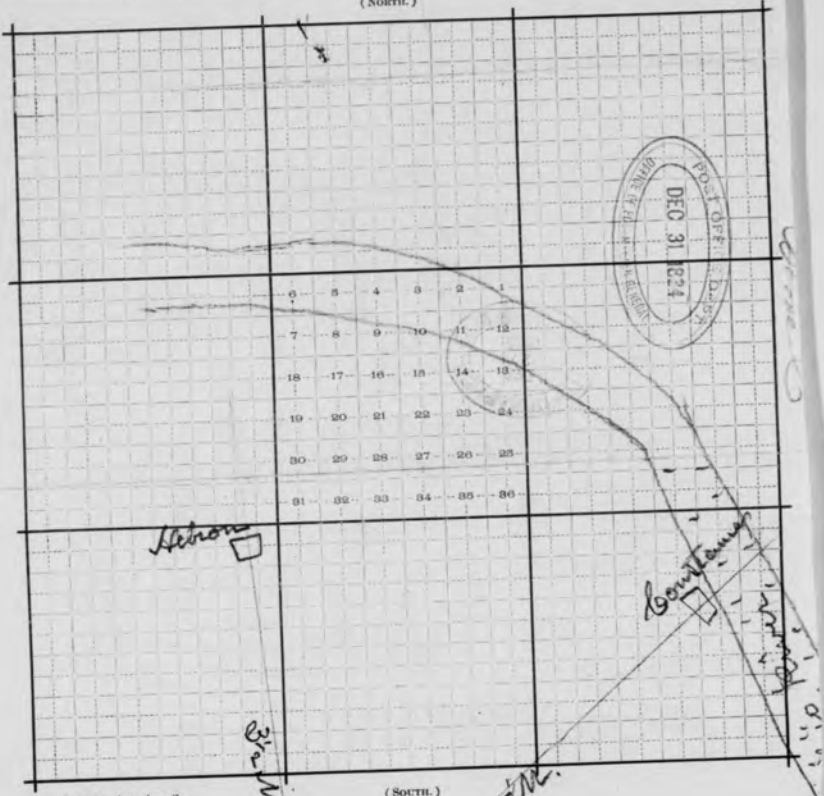

Scale 1/4 inch to the mile.

(SOUTH)

Burlington

2 1/2 M. Burlington

3 1/2 M.

Post office

6 M.

Union

Gunpowder

5 M.

4 1/2 M. of Louisa Turnpike

4 M.

Louisa

*M S Rice
 Surveyor
 Dec. 27. 1884*