

POST OFFICE DEPARTMENT,  
TOPOGRAPHER'S OFFICE,

Washington, August 22, 1885

Sir:

To enable the Topographer of this Department to determine, with as much accuracy as possible, the relative positions of Post Offices, so that they may be correctly delineated on its maps, the Postmaster General requests you to fill up the spaces and answer the questions below, and return the same, verified by your signature and dated, under cover to this Office.

Respectfully, &c.,

W. L. Hildner  
Topographer P. O. Dept.

To POSTMASTER AT Milford  
Bracken Co.  
Kentucky  
Milford

The (P. O. Dept.) name of my Office is

\* Its local name is

It is situated in B part of Milford Precinct Township, County of Bracken, State of Dep quarter of Tract No.

The name of the most prominent river near it is Licking

The name of the nearest creek is North Fork of Licking

This Office is 5 miles from said river, on the North side of it, and is on miles from said nearest creek, on the South side of it.

The name of the nearest Office on route No. 29119 is Petra, and its distance is 3 1/2 miles, by the traveled road, in a N-E direction from this my Office.

The name of the nearest Office, on the same route, on the other side, is Waycross and its distance is 5 miles in a South direction from this my Office.

The name of the nearest Office off the route is \_\_\_\_\_, and its distance by the most direct road is \_\_\_\_\_ miles in a \_\_\_\_\_ direction from this my Office.

This Office is at a distance of 1 1/2 from the Halewood Station of the N. C. Railroad, on the North East side of the railroad.

State, under this, the names of all other Offices near your Office, in different directions from it, and their distances from it by the most direct roads.

\* If the town, village, or site of the Post Office be known locally by another name than that of the Post Office, state that other name here, that it may be identified on any published map of the State (or Territory) if appearing thereon.

EP A diagram of the township (or, where the land is not so divided, a sketch map), showing the precise location of your Office, together with the adjoining Post Offices, towns, or villages, the roads, railroads, and larger streams or creeks, in addition to the above verbal description, will be useful, and is desired.

A correct map of the locality and adjacent country might be furnished by your County Surveyor, but this must be without expense to the Post Office Department; it being, however, for the general interest and advantage of the community to have the Post Offices correctly located on the maps, it may be expected that this will be cheerfully furnished on proper application.

State (in margin of this sheet) whether there is on file at your county seat (court-house), or in the hands of your County Surveyor, a Map of the county.

State also the present Surveyor's name and Post Office address.

(Signature of Postmaster.)

(Date.)

A. Brough, P. M.  
Aug 24/85

Map of County at County Seat, for with Surveyor

James B. Camp County Surveyor Milford Dep

Ohio River

Bracken

Rockville (Ct.)

Pawinsville P.O.

County

County Line

North

Milford P.O.

Precinct  
Mt. Hope P.O.



N Fork of Licking R.

Propound P.O.  
Map

Milford P.O.  
20,115

20,114  
20,113  
20,112  
20,111  
20,110  
20,109  
20,108  
20,107  
20,106  
20,105  
20,104  
20,103  
20,102  
20,101  
20,100  
20,099  
20,098  
20,097  
20,096  
20,095  
20,094  
20,093  
20,092  
20,091  
20,090  
20,089  
20,088  
20,087  
20,086  
20,085  
20,084  
20,083  
20,082  
20,081  
20,080  
20,079  
20,078  
20,077  
20,076  
20,075  
20,074  
20,073  
20,072  
20,071  
20,070  
20,069  
20,068  
20,067  
20,066  
20,065  
20,064  
20,063  
20,062  
20,061  
20,060  
20,059  
20,058  
20,057  
20,056  
20,055  
20,054  
20,053  
20,052  
20,051  
20,050  
20,049  
20,048  
20,047  
20,046  
20,045  
20,044  
20,043  
20,042  
20,041  
20,040  
20,039  
20,038  
20,037  
20,036  
20,035  
20,034  
20,033  
20,032  
20,031  
20,030  
20,029  
20,028  
20,027  
20,026  
20,025  
20,024  
20,023  
20,022  
20,021  
20,020  
20,019  
20,018  
20,017  
20,016  
20,015  
20,014  
20,013  
20,012  
20,011  
20,010  
20,009  
20,008  
20,007  
20,006  
20,005  
20,004  
20,003  
20,002  
20,001

20,552  
Danta 742

20,562  
Bosaton P.O.

County Line

Robertson Co

about  
Mt. Olive P.O.

son Co

Rockville

Division of Supplies  
DIVISION OF TOPOGRAPHY



Post Office Department  
FOURTH ASSISTANT POSTMASTER GENERAL  
Washington, Dec 27, 1913

SIR:

In order that the site of your post office may be accurately represented upon the post-route maps, it is requested that you carefully answer the questions below and furnish a sketch, according to instructions on opposite side of paper, which should be returned to this Division as soon as possible. Respectfully,

To Postmaster at Milford

Bracken Co,

Ky.

*[Signature]*  
Fourth Assistant Postmaster General.

The name of my post office is Milford

If the town, village, or site of the post office be known by another name than that of the post office, state that other name here: \_\_\_\_\_

My post office is situated in the South part of \_\_\_\_\_ Township,  
or in \_\_\_\_\_ quarter of tract \_\_\_\_\_ Number \_\_\_\_\_ Township,

County of Bracken, State of Ky

The name of the nearest river is \_\_\_\_\_, and the post-office building is at a distance of \_\_\_\_\_ on the \_\_\_\_\_ side of it.

The name of the nearest creek is North Fork of Jackson, and the post-office building is at a distance of 100 yds on the west side of it.

The name of the nearest office on my route is Brooksville  
and its distance is 10 miles, by the traveled road, in a North direction from this, my office.

The name of the nearest office on my route, on the other side, is Bratton  
and its distance is 4 miles, in a East direction from this, my office.

The name of the nearest office not on my route is Claysville  
and its distance is 5 miles, by the traveled road, in a South direction from this, my office.

The post-office building is on the \_\_\_\_\_ side of the \_\_\_\_\_ Railroad,  
and at a distance of \_\_\_\_\_ from the track.

The railroad station name is \_\_\_\_\_

My post office is 2 miles, air-line distance, 5 from the nearest point of my county boundary.

Postmaster: *[Signature]*

Date: Jan 2, '14

DIAGRAM, EXPLANATION, AND INSTRUCTIONS.

The dot in the center of the 1-mile circle represents the site of the post office.  
The surrounding offices should be carefully located by placing dots on or between the mile circles at the exact distance, and in the right direction, from the post office, and their names plainly written.  
Draw distinctly the railways, roads, rivers, and creeks.

5-4225

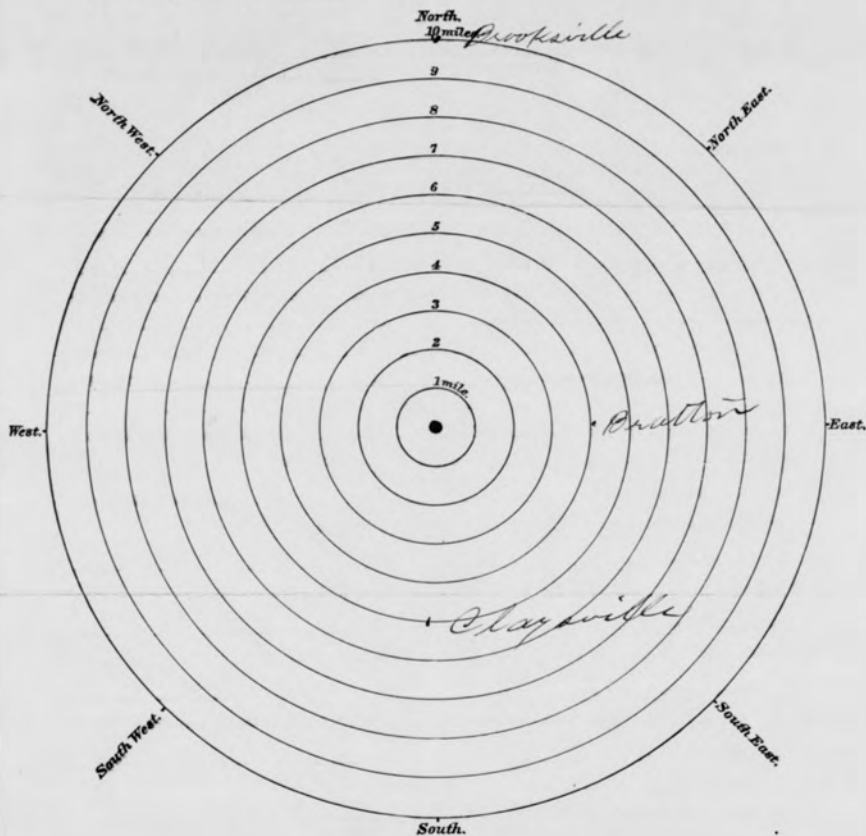

Post Office Department  
FOURTH ASSISTANT POSTMASTER GENERAL

Washington May 16, 1922

Postmaster, Milford  
Bracken Co  
Ky.

For change of site.

TOPOGRAPHY BRANCH  
MAY 21 1922  
DIVISION OF EQUIPMENT  
AND SUPPLIES  
POST OFFICE DEPT.

In order that the site of your post office may be accurately represented upon the post-route maps, it is requested that you carefully answer the questions below and furnish a sketch, according to instructions on opposite side of paper, which should be returned to this Division as soon as possible.

FOURTH ASSISTANT POSTMASTER GENERAL

The name of my post office is Milford Kentucky

If the town, village, or site of the post office be known by another name than that of the post office, state that other name here:

My post office is situated in the \_\_\_\_\_ part of \_\_\_\_\_ Township,  
or in \_\_\_\_\_ quarter of \_\_\_\_\_ Township,

County of Bracken State of Kentucky

The name of the nearest river is North Ficken and the post-office building is at a distance of three hundred yds the South-east of it.  
N., S., E., or W.

The name of the nearest creek is \_\_\_\_\_ and the post-office building is at a distance of \_\_\_\_\_ on the \_\_\_\_\_ side of it.  
N., S., E., or W.

The name of the nearest office on my route is Brooksville Ky  
and its distance is 9 miles, by the traveled road, in a North direction from this, my office.  
N., S., E., or W.

The name of the nearest office on my route, on the other side, is Bratton  
and its distance is 4.2 miles, in a East direction from this, my office.  
N., S., E., or W.

The name of the nearest office not on my route is Cay Station Ky  
and its distance is 18 miles, by the traveled road, in a South W direction from this, my office.  
N., S., E., or W.

The post-office building is on the South side of the Brooksville Sta Railroad,  
and at a distance of 9 mds from the track.  
N., S., E., or W.

The railroad station name is Co & O. Brack and B & W.

The air-line distance from my post office to the nearest point of my county boundary is 2 miles  
in a South direction.  
N., S., E., or W.

Postmaster: Fannie M Casey

Date: May 26 1922

DIAGRAM, EXPLANATION, AND INSTRUCTIONS.

The dot in the center of the 1-mile circle represents the site of the post office.  
The surrounding offices should be carefully located by placing dots on or between the mile circles at the exact distance,  
and in the right direction, from the post office, and their names plainly written.  
Draw distinctly the railways, roads, rivers, and creeks.

1-1025

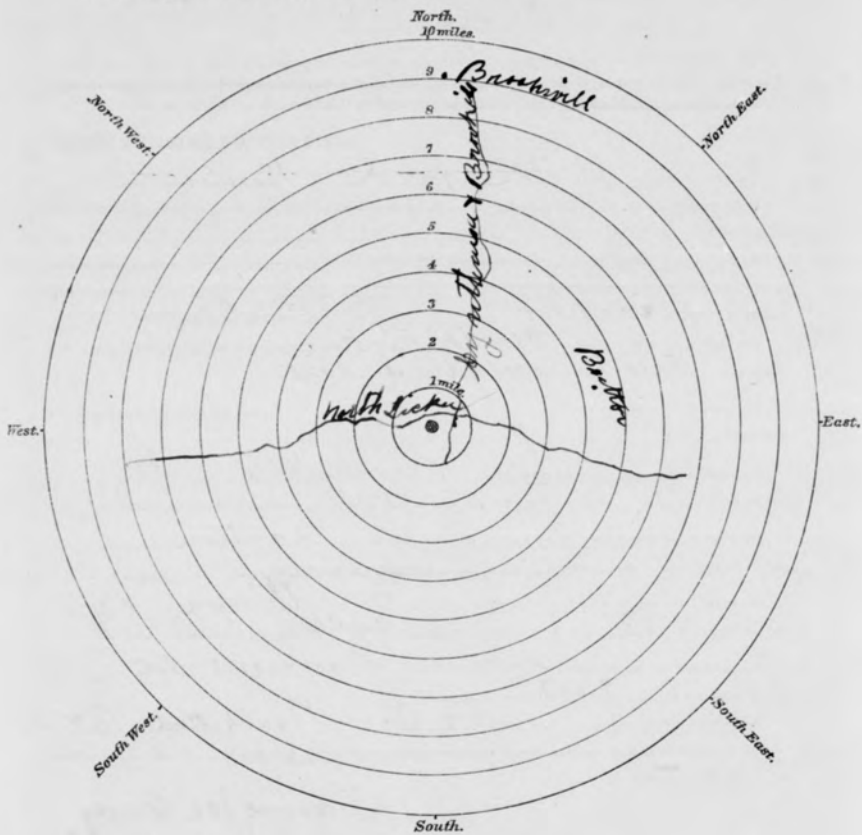

**Post Office Department**  
**FOURTH ASSISTANT POSTMASTER GENERAL**  
 Washington

M

RETURN TO  
 DIVISION OF TOPOGRAPHY

Postmaster,

JUL 20 1939

MILFORD,

KY.

The following information is required in order that your post office may be shown in its proper location on postal maps. Please complete this form immediately and return it without delay with the map or sketch described on the reverse side. A letter of reply is not necessary.

*S. W. Wurdum*  
 FOURTH ASSISTANT POSTMASTER GENERAL.

1. Street address of post office \_\_\_\_\_ County Bracken
2. Township \_\_\_\_\_ (If location is described by section, township, and range, fill in line 3.)
3. \_\_\_\_\_ quarter of section \_\_\_\_\_ Township \_\_\_\_\_ N. or S. \_\_\_\_\_ Range \_\_\_\_\_ E. or W. \_\_\_\_\_
4. Nearest adjoining county Robertson How far: Shortest air distance? \_\_\_\_\_ By road? 2 mi.
5. Nearest U. S. or State highway No. 19 Direction from P. O. on 19 Distance \_\_\_\_\_
6. Name of nearest railroad station Cynthiana Name of railroad B. & N.
7. Distance by road to railroad station 1.8 miles Direction from post office South
8. Shortest air distance to nearest tracks \_\_\_\_\_ Direction from post office \_\_\_\_\_
9. Nearest streams or bodies of water (state whether river, creek, branch, lake, ocean, etc.):  

Name	Direction from post office	Distance
<u>North Fork of Licking River</u>	<u>East</u>	<u>250 ft.</u>

10. Post offices nearest to your office (one in each general direction):

Name	County	Direction from your office	Distance by road
<u>Bratton</u>	<u>Robertson</u>	<u>East</u>	<u>5 mi.</u>
<u>Brooksville</u>	<u>Bracken</u>	<u>North</u>	<u>10 mi.</u>
<u>Falmouth</u>	<u>Pendleton</u>	<u>West</u>	<u>11 "</u>
<u>Cynthiana</u>	<u>Harrison</u>	<u>South</u>	<u>18 "</u>

11. How is mail supplied to your office? State Route From where? Mt. Olivet  
(Railroad, star route, rural route, etc.) Brooksville, Ky.  
Rural R.

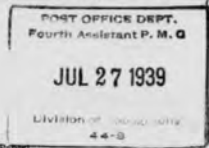

(Date) July 24, 1939.  
 (Signed) Lucey Howard Postmaster.  
 Post office Milford, Ky.

4901-2-111 (Location Paper)

(OVER)

8-11054

*Pencil Sketch*

Milford N.Y.

this  
sense  
square

l  
t  
h  
C  
P  
a  
r  
r  
(  
e  
s  
w  
i  
c  
l  
o  
S  
t  
p  
o  
s  
a  
b  
y  
e

20.

U  
is N  
by a  
L  
repr  
T  
and  
scale  
inch equ

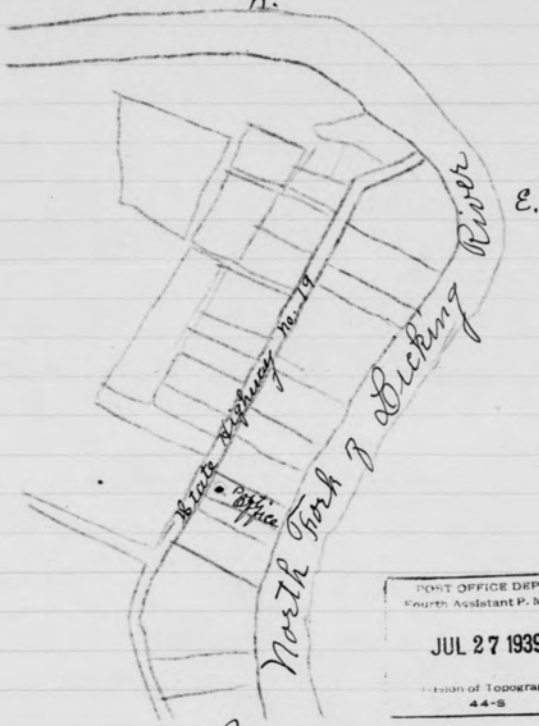

POST OFFICE DEPT.  
Fourth Assistant P. M. G  
**JUL 27 1939**  
Division of Topography  
44-B

s.

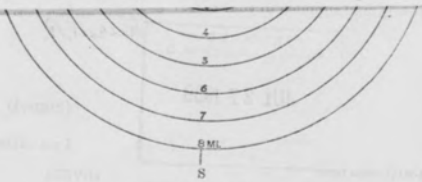

Scale: 1/4 inch equals 1 mile



Division of Postmasters

**Post Office Department**

FIRST ASSISTANT POSTMASTER GENERAL

Washington 25, D. C.

*AS*  
*Milford Ky*

SUBJECT:  Establishment  
 Reestablishment  
 Change of site

In order that each post office may be accurately located on postal maps, it is requested that you carefully complete this form and return it promptly to the First Assistant Postmaster General, Division of Postmasters.

Respectfully,

First Assistant Postmaster General.

1. Office and State Milford, Kentucky County cracken
- 1a. Any other name by which locality is known NONE (If applicable, fill in line 3.)
2. Township \_\_\_\_\_
3. \_\_\_\_\_ quarter of section \_\_\_\_\_ Township \_\_\_\_\_ N. or S. \_\_\_\_\_ Range \_\_\_\_\_ E. or W. \_\_\_\_\_
4. Nearest adjoining county Harrison How far? Shortest map distance 1 1/2 mi. By road 2 mi.
- 4a. If site is being changed: Distance from old site 250 yds. Direction from old site East
5. Nearest ~~U.S.~~ State highway 19 Direction from P. O. Highway Distance On highway
6. Name of nearest railroad station Cynthiana, Kentucky Name of railroad L&N RR
7. Distance by road to railroad station 18 mi. Direction from post office South
8. Shortest air distance to nearest tracks 15 mi. Direction from post office South
9. Streams or bodies of water nearest to the office:

Name	Direction from post office	Distance
<u>North Fork Licking River</u>	<u>East</u>	<u>125 feet</u>

10. Direction of nearest post offices (one in each general direction):
- | Name                   | County           | Direction from your post office | Distance by road |
|------------------------|------------------|---------------------------------|------------------|
| <u>Brookville, Ky.</u> | <u>cracken</u>   | <u>North East</u>               | <u>10 miles</u>  |
| <u>Mt. Olivet, Ky.</u> | <u>Robertson</u> | <u>South East</u>               | <u>17 miles</u>  |
| <u>Cynthiana, Ky.</u>  | <u>Harrison</u>  | <u>South West</u>               | <u>18 miles</u>  |
| <u>Falmouth, Ky.</u>   | <u>Butler</u>    | <u>North West</u>               | <u>20 miles</u>  |
11. Method of mail supply Star Route - Rural Route From where \*Mt. Olivet, Ky.  
(Railroad, star route, rural route, etc.)
12. Congressional district: Present site 8th Proposed site 8th

*if to agent*



*Agnes Kinsey*  
(Signature in full)  
**Acting Postmaster**  
(Postal title)  
November 3, 1947.  
(Date)

**IMPORTANT.**—A map showing the location of the post office must be submitted with the return of this paper. A highway map such as prepared by State, county, or local agencies is preferred, if it can be furnished without expense to the Department. Be sure, however, to mark on it the exact site of the post office, placing a small dot in the proper square or block and on the proper side of the street.

If no map can be furnished it is necessary to draw a sketch on one of the diagrams below.

### INSTRUCTIONS

These diagrams are furnished simply to make it easier to draw a sketch that will show correct distances from the post office.

#### SQUARE DIAGRAM

Use this diagram if the post office is located in an area described by section, township, and range, and you have filled in line 3 on the other side. Otherwise use the circular diagram.

Place a small dot representing the post office in the proper quarter-section and fill in the blanks for township and range numbers.

Then draw the following features: (Note that one-half inch on the paper equals 1 mile on the ground.)

- Adjacent post offices (show with small dots and name).
- Railroads (show by single line with cross marks; name).
- Highways (show by double lines close together and mark U. S. and State numbers; name in margin the post office to which each road leads).
- Rivers, creeks, lakes, etc. (show by wavy lines and name).
- County line (show by dashes).

#### CIRCULAR DIAGRAM

Use this diagram if the post office is NOT located in an area described by section, township, and range.

Let the dot in the center of the circle represent the post office.

Then draw the features a, b, c, d, and e, as described above. (Note the scale of this diagram: One-quarter inch equals 1 mile.)

