

KENTUCKY HISTORIC RESOURCES
Individual Inventory Form

DEC 28 1988

Resource # Be-370
County

<p>1. Name of Resource: Edwards house</p> <p>2. Original Owner: Mrs. Edwards</p> <p>3. Other Names: Residence of the Sisters of St. Joseph the Worker</p> <p>4. Prehistoric Site <input type="checkbox"/> Building <input checked="" type="checkbox"/> Object <input type="checkbox"/> Historic Site Structure Other</p> <p>5. Location: 143 South Main Street Walton, KY</p> <p>6. Owner's Name: Sisters of St. Joseph the Worker []</p> <p>7. Owner's Address: 143 South Main Street Walton, KY 41094</p> <p>8. Evaluation: National Register []</p> <p>9. Recognition & Date: Nat.Landmark _____ Local Landmark _____ Nat.Register _____ HABS/HAER _____ Highway Marker _____ KY Inventory 1987 _____ KY Landmark Certificate _____</p> <p>10. N.R.Status & Date:</p> <p>11. N.R.Group: District Name: [] Mult.Resource Area: Boone County [] Thematic Name: []</p> <p>12. Historical Theme: Primary: Architecture [] Secondary: [] Other: []</p> <p>13. Statement of Significance: This property is significant under criterion C as a good example of the Foursquare house type, significant to Boone County in the period 1900-1930. The Foursquare type consists of a nearly cubical, two-story block with a low pyramidal roof, a symmetrical, two-bay facade and a plan (Continued) []</p>	<p>16. Date: Original Building c. 1910-1915 [] Addition mid-20th c. []</p> <p>17. Style: Colonial (Georgian) Revival []</p> <p>18. Architect/Builder: unknown</p> <p>19. No. of Stories: 2 1/2 []</p> <p>20. Original Floor Plan: Foursquare []</p> <p>21. Single Pile Double Pile N.A. X</p> <p>22. Roof Form & Material: Original X Not Original</p> <p>23. Structural Material: brick []</p> <p>24. Exterior Material: common bond brick [] aluminum siding (eaves & dormers) []</p> <p>25. Foundation Material: poured concrete w/simulated joints []</p> <p>26. Major Alterations: None Moved/Rebuilt Other X Additions</p> <p>27. Special Features: 2 tones of brick, highlights quoins & dentils</p> <p>28. Outbuildings: two: carriage hs./stable & garage []</p> <p>29. Original Function: dwelling []</p> <p>30. Present Use: dwelling []</p> <p>31. Condition: excellent []</p> <p>32. Endangered: Yes No X</p> <p>33. Attach Photos: Roll: 14 Photo Nos: 36 No. of Slides: 15 1-4</p>
--	--

14. History:

The house was built for a Mrs. Edwards.

15. Source of historical information and/or contact person: owner

34. Prepared by: Kenneth T. Gibbs
35. Organization: Boone Co. Hist. Pres. Rev. Bldg
36. Date: September 1986
37. New Survey X Resurvey

KENTUCKY HISTORIC RESOURCES
Individual Inventory Form

Resource # Be-370

38. UTM Point of Primary Building: Zone Easting Northing 39. G.I.S. Mod. []
Quadrant: Walton 16 7070600 4303355 40. Coordi. Accuracy []

41. UTM Points of Boundary (for N. R. eligible sites only):

A. --- D. ---
B. --- E. ---
C. --- F. ---

42. Total Acreage in Present Property: 10 43. Acreage included in proposed N.R. boundary: 2

44. Site Plan (and boundary description and justification for N.R. sites):

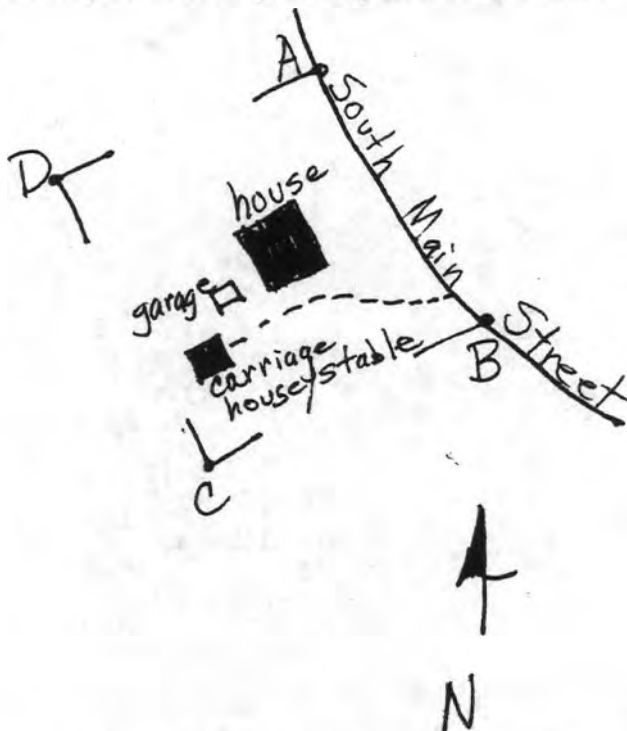

The nominated property occupies the southeast 300' of city lot W4-5-17 and is roughly 300' x 300' in size. The boundary, shown by the points A, B, C and D, includes the house, carriage house-stable and the part of the city lot historically associated with the property that has maintained its integrity. The remainder of the lot contains a more recent brick structure. The boundary A-B is on the west side of South Main Street.

Contributing: 2 buildings
Noncontributing: 1 building (garage)

45. Description and House Plan:

The nearly cubical mass of this brick, two-story building--there is a short 2-story ell--is its most prominent feature. All roofs are hipped, including the full-length front porch, the porch in the angle of the ell, and the three dormers. The brick used for the walls is buff-colored, while the brick used in the quoins and the "dentils" in the corbeled cornice are a dark brown. The use of aluminum siding in the eaves and the dormers does not seem to seriously affect the overall integrity of the building. All the openings are topped with plain stone lintels. The front door consists of a simple unit of transom, sidelights and lighted door.

Decorative glass used in the house includes leaded, beveled glasswork in the transom and sidelights and in the first-floor, front window, stained glass in the middle window of the northern projecting bay, and leaded diamond panes in the dining room cupboards. Simple, Craftsman-style woodwork finishes the interior openings, and the same style was used in the parlor mantel, topped with a beveled mirror. The double mantel in the dining room also has a mirror. The coal grates are framed with white tile.

The frame outbuilding originally used as a carriage house-stable seems to be contemporary to the house, but the hip-roofed garage seems to be somewhat later, extended in the middle 20th century with a 2-car garage and space for living quarters; in the process it has lost integrity.

United States Department of the Interior
National Park Service

FEB 13 1989

**National Register of Historic Places
Continuation Sheet**

Section number 13 Page 3 of 3

Edwards House (Be-370)
Historic Resources of Boone County,
Kentucky, Partial Inventory MRA

(continuation of item 13, Statement of Significance)

of 4 main rooms on each floor. An uncommon type in Boone County, the Foursquare house was observed only in the Railroad town of Walton, a town built primarily between 1890 and 1930. Two other examples of the type were built near this property, but they lack the original detailing and historic setting found here. Boone County examples of the type were built of either frame or brick construction with full-width, one-story porches, hipped dormers, and very simple detailing.

This property is significant to Boone County as a good example among very few properties of a house type that was very popular nationally during this period.

United States Department of the Interior
National Park ServiceNational Register of Historic Places
Continuation Sheet

Section number _____ Page _____

Multiple Resource Area
Thematic GroupName Boone County MRA
State KENTUCKY

Nomination/Type of Review

Date/Signature

21. Crouch, Dr. M.J., House

Entered in the
National RegisterKeeper Delores Byers 2/6/89

Attest _____

22. Delehunty, John, House

Entered in the
National RegisterKeeper Delores Byers 2/6/89

Attest _____

23. Delph, Sam, House

Entered in the
National RegisterKeeper Delores Byers 2/6/89

Attest _____

24. Delph, W.T., House

Entered in the
National RegisterKeeper Delores Byers 2/6/89

Attest _____

25. Dew, Daniel, House

Entered in the
National RegisterKeeper Delores Byers 2/6/89

Attest _____

26. Early House

Entered in the
National RegisterKeeper Delores Byers 2/6/89

Attest _____

27. East Bend Church

Entered in the
National RegisterKeeper Delores Byers 2/6/89

Attest _____

5611 28. Edwards House

Substantive Review

for Keeper Patrick Andrews 2/7/89

Attest _____

29. Farmers Bank of Petersburg

Entered in the
National RegisterKeeper Delores Byers 2/6/89

Attest _____

30. Flick House

Entered in the
National RegisterKeeper Delores Byers 2/6/89

Attest _____

United States Department of the Interior
National Park Service

National Register of Historic Places
Continuation Sheet

Section number _____ Page _____

SUPPLEMENTARY LISTING RECORD

NRIS Reference Number: 88003304

Date Listed: 2/7/89

Edwards House
Property Name

Boone
County

KY
State

Multiple Name

This property is listed in the National Register of Historic Places in accordance with the attached nomination documentation subject to the following exceptions, exclusions, or amendments, notwithstanding the National Park Service certification included in the nomination documentation.

Patrick Andrus
Signature of the Keeper

2/7/89
Date of Action

=====

Amended Items in Nomination:

The UTM provided for this property was inaccurate (too many numbers). Marty Perry with the KY SHPO has provided the correct UTM point: 16 E 707600/N4303355.

DISTRIBUTION:

National Register property file
Nominating Authority (without nomination attachment)

405 SLR

UNITED STATES DEPARTMENT OF THE INTERIOR
NATIONAL PARK SERVICE

NATIONAL REGISTER OF HISTORIC PLACES
EVALUATION/RETURN SHEET

REQUESTED ACTION: NOMINATION

PROPERTY Edwards House
NAME:

MULTIPLE Boone County MRA
NAME:

STATE & COUNTY: KENTUCKY, Boone

DATE RECEIVED: 12/28/88 DATE OF PENDING LIST: 1/10/89
DATE OF 16TH DAY: 1/26/89 DATE OF 45TH DAY: 2/11/89
DATE OF WEEKLY LIST:

REFERENCE NUMBER: 88003304

NOMINATOR: STATE

REASONS FOR REVIEW:

APPEAL: N DATA PROBLEM: N LANDSCAPE: N LESS THAN 50 YEARS: N
OTHER: N PDIL: N PERIOD: N PROGRAM UNAPPROVED: N
REQUEST: N SAMPLE: N SLR DRAFT: Y NATIONAL: N

COMMENT WAIVER: N

☒ ACCEPT ☐ RETURN ☐ REJECT 2/7/89 DATE

ABSTRACT/SUMMARY COMMENTS:

nomination has a problem with the UTM

See SLR

missing continuation sheet

Building is architecturally significant

RECOM./CRITERIA accept c
REVIEWER Patrick Andrus
DISCIPLINE Historian
DATE 2/6/89

DOCUMENTATION see attached comments Y/N see attached SLR Y/N

CLASSIFICATION

___count ___resource type

STATE/FEDERAL AGENCY CERTIFICATION

FUNCTION

___historic ___current

DESCRIPTION

___architectural classification
___materials
___descriptive text

SIGNIFICANCE

Period Areas of Significance--Check and justify below

Specific dates Builder/Architect
Statement of Significance (in one paragraph)

___summary paragraph
___completeness
___clarity
___applicable criteria
___justification of areas checked
___relating significance to the resource
___context
___relationship of integrity to significance
___justification of exception
___other

BIBLIOGRAPHY

GEOGRAPHICAL DATA

___acreage ___verbal boundary description
___UTMs ___boundary justification

ACCOMPANYING DOCUMENTATION/PRESENTATION

___sketch maps ___USGS maps ___photographs ___presentation

OTHER COMMENTS

Questions concerning this nomination may be directed to

Phone _____

Signed _____

Date _____







Please refer to the map in the
Multiple Property Cover Sheet
for this property

Multiple Property Cover Sheet Reference Number: 64000206



KENTUCKY HERITAGE COUNCIL
The State Historic Preservation Office

February 8, 1989

Jerry Rogers, Keeper
Registration Section
National Register of Historic Places
National Park Service
1100 L Street NW
Washington, DC 20240

FEB 13 1989

NATIONAL
REGISTER

Dear Mr. Rogers:

Please find enclosed a continuation sheet which was inadvertently omitted from the submission for the property below:

Edwards House
Historic Resources of Boone County, Kentucky, Partial Inventory, MRA

Thank you for your consideration.

Sincerely,

David L. Morgan
State Historic Preservation Officer

MP/mp
enclosure