

KENTUCKY HISTORIC RESOURCES INVENTORY

1. Name of Site: Jacob Hunter House	16. Date: ca. 1818 [8]
2. Prehistoric Site Building X Object Historic Site Structure Other	17. Style: Federal Vernacular [2V]
3. Location: 1.6 mile west of Salem Church on north side ca. 200 yards from road, across road from Big South Fork of Kentucky River,	18. Architect/Builder:
4. ADD/County: <i>New Liberty</i> [94] Owen County	19. No. of Stories: 1 plus garret & cellar [1]
5. Original Owner: Jacob Hunter	20. Original Floor Plan: Single Cell [1R]
6. Other Names:	21. Single Pile X Double Pile N.A.
7. Owners Name: Mrs. Martha Roberts	22. Roof Form & Original Material: Gable
8. Owners Address: Worthville, Kentucky 41098	23. Structural Material: Stone [S]
9. Evaluation: [N] National Register Theme	24. Exterior Finish: Stone [S]
10. Status & Date: Nat. Landmark KY Survey Nat. Register Local Landmark Landmark Cert. HABS/HAER	25. Foundation Material: Stone [S]
11. N.R. Group: District Name [] Mult. Resource Area [] Thematic Name Early Stone Buildings []	26. Major Alterations: Moved Wall Treat. Additions None
12. Historical Theme: Primary: Settlement [140] Secondary: Architecture [030] Other: []	27. Outbuildings: []
13. Statement of Significance: Ruins of early stone house; only one in Owen County, only one bay stone house in Kentucky; good historic archaeological site; unchanged except by nature.	28. Original Use: Residence [01A]
14. History: Built by Jacob Hunter. Rev. War veteran grandson was Lafayette Hunter.	29. Present Use: Ruins
	30. Condition: Ruins [R]
	31. Endangered: Yes [] No [X]
	32. Attach Photos Roll: Stone 29 Photo Nos: 14 - 17
15. Source of Historical Information: Pat Wolcott, Rt. #3, Sugar Hill Farm, Owenton, KY & Beulah Joshlin (502-484-3804), granddaughter of Lafayette Hunter.	33. Prepared by: Carolyn Murray Wooley
	34. Organization: Kentucky Heritage Council
	35. Date: April 1984 [6]

KENTUCKY HISTORIC RESOURCES INVENTORY

36. UTM Point of Primary Building: <u>16 677490 4269150</u>	37. USGS Quadrant: <u>New Liberty</u>	38. G.I.S. Mod. []
40. UTM Points of Boundary:		39. Coordinate Accuracy []
A. <u>16 677590 4269015</u>	C. <u>16 677480 4269290</u>	E. _____
B. <u>16 677350 4269200</u>	D. <u>16 677620 4269170</u>	F. _____
41. Total Acreage in Present Property: _____	42. Acreage Included in Nominated Boundary: <u>//</u>	
43. Site Plan and Boundary Description and Justification:		

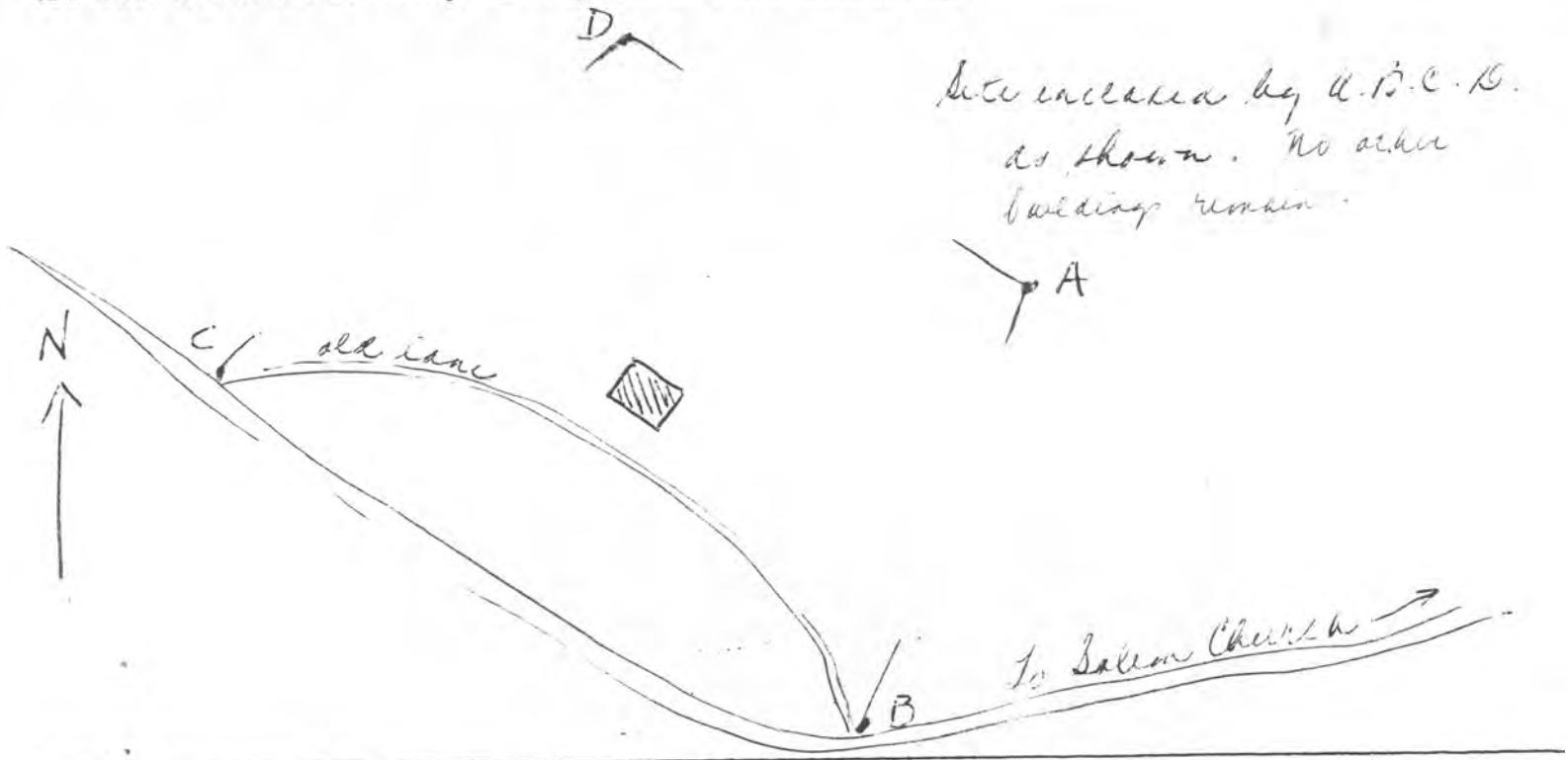

44. Description and House Plan:

Unique one-story, single cell, dry stone house with exterior gable end chimney. Full cellar with exterior entrance. House had wooden stoop on center of front, in front of the door which was the only opening in the front wall other than cellar. One window only in center of north wall, one window in center of west wall, and fireplace centered in east wall—common plan for primitive log house, but singular in stone. Part of one window frame remains, which has solid board reveal and ovolo trim.

Said by descendant to have had ladder-like stair to upstairs bedroom, which had small square windows (presumably in gable ends).

NATIONAL REGISTER OF HISTORIC PLACES
EVALUATION/RETURN SHEET

Hunter, Jacob, House (Early Stone Buildings of
Kentucky TR)
Owen County
KENTUCKY

Substantive Review

Working No. JUN 6 1985
Fed. Reg. Date: _____
Date Due: 7/4/85 - 7/21/85
Action: ACCEPT
 RETURN 7-21-85
REJECT
Federal Agency: _____

- resubmission
- nomination by person or local government
- owner objection
- appeal

Substantive Review: sample request appeal NR decision

Reviewer's comments:

See letter

Recom./Criteria _____ *lit*
Reviewer _____
Discipline _____
Date _____
_____ see continuation sheet

Nomination returned for: technical corrections cited below
 substantive reasons discussed below

1. Name

2. Location

3. Classification

Category	Ownership	Status	Present Use
	Public Acquisition	Accessible	

4. Owner of Property

5. Location of Legal Description

6. Representation in Existing Surveys

Has this property been determined eligible? yes no

7. Description

Condition		Check one	Check one
<input type="checkbox"/> excellent	<input type="checkbox"/> deteriorated	<input type="checkbox"/> unaltered	<input type="checkbox"/> original site
<input type="checkbox"/> good	<input type="checkbox"/> ruins	<input type="checkbox"/> altered	<input type="checkbox"/> moved date _____
<input type="checkbox"/> fair	<input type="checkbox"/> unexposed		

Describe the present and original (if known) physical appearance

- summary paragraph
- completeness
- clarity
- alterations/integrity
- dates
- boundary selection

8. Significance

Period Areas of Significance—Check and justify below

Specific dates

~~Builder/Architect~~ *OK*

Statement of Significance (in one paragraph)

- summary paragraph
- completeness
- clarity
- applicable criteria
- justification of areas checked
- relating significance to the resource
- context
- relationship of integrity to significance
- justification of exception
- other

9. Major Bibliographical References

10. Geographical Data

Acreage of nominated property _____
Quadrangle name _____
UTM References _____

X Verbal boundary description and justification

11. Form Prepared By

12. State Historic Preservation Officer Certification

The evaluated significance of this property within the state is:

____ national ____ state ____ local

State Historic Preservation Officer signature

title _____ date _____

13. Other

- Maps
- Photographs
- Other

Questions concerning this nomination may be directed to _____

Signed Carol O. Shuel Date 7-21-85 Phone: _____

NOV 26 1986

KENTUCKY HISTORIC RESOURCES
Individual Inventory Form

Resource # ON-19
Owen County

1. Name of Resource:
Jacob Hunter House

2. Original Owner:
Jacob Hunter

3. Other Names:

4. Prehistoric Site _____ Building Object
Historic Site _____ Structure _____ Other _____

5. Location: 1.6 miles west of Salem Church on north side 200 yards from road, across road from Big South Fork, near New Liberty

6. Owner's Name:
Mrs. Martha Roberts [P]

7. Owner's Address:
Worthville, Kentucky 41098

8. Evaluation: [G]

9. Recognition & Date:
Nat.Landmark _____ Local Landmark _____
Nat.Register _____ HABS/HAER _____
Highway Marker _____ KY Inventory
KY Landmark Certificate _____

10. N.R.Status & Date:

11. N.R.Group:
District Name: []
Mult.Resource Area: []
Thematic Name: Early Stone Buildings []

12. Historical Theme:
Primary: Settlement [140]
Secondary: Architecture [030]
Other: []

13. Statement of Significance:
Ruins of early stone house; only one in Owen County, only one of two one-bay stone houses in Kentucky; good historic archaeological site; unchanged except by nature.
[]

14. History:
Built by Jacob Hunter. Revolutionary War Veteran grandson was Lafayette Hunter.

16. Date:
Original Building Ca. 1818 [8]
Addition []

17. Style:
Federal Vern. [21]

18. Architect/Builder: Not Known

19. No. of Stories: 1 plus garrett, cellar 1 []

20. Original Floor Plan:
Single Cell [1R]

21. Single Pile Double Pile _____ N.A. _____

22. Roof Form & Material: Original
Gable Not Original _____

23. Structural Material:
Stone [S]

24. Exterior Material:
Stone [S]

25. Foundation Material:
Stone [S]

26. Major Alterations: None
Moved/Rebuilt Other _____
Additions

27. Special Features:

28. Outbuildings:
None [0]

29. Original Function:
Residence [01A]

30. Present Use:
Ruins [9V]

31. Condition:
Ruins [R]

32. Endangered: Yes
by nature No _____

33. Attach Photos:
Roll: 29 Photo Nos: 14-17 No. of Slides: _____

15. Source of historical information and/or contact person: Pat Wolcott, Rt.#3, Sugar Hill Farm, Owenton, Kentucky; and Beulah Joshlin (502/484-3804), grand daughter of Lafayette Hunter

34. Prepared by: Carolyn Murray-Wooley

35. Organization: Kentucky Heritage Council

36. Date: April 1984

37. New Survey Resurvey _____

KENTUCKY HISTORIC RESOURCES INVENTORY

36. UTM Point of Primary Building: <u>16 677490 4269150</u>	37. USGS Quadrant: <u>New Liberty</u>	38. G.I.S. Mod. []
40. UTM Points of Boundary: A. <u>16 677590 4269015</u> B. <u>16 677350 4269200</u>	C. <u>16 677480 4269290</u> D. <u>16 677620 4269170</u>	E. [] F. []
41. Total Acreage in Present Property:	42. Acreage Included in Nominated Boundary: <u>//</u>	
43. Site Plan and Boundary Description and Justification:		

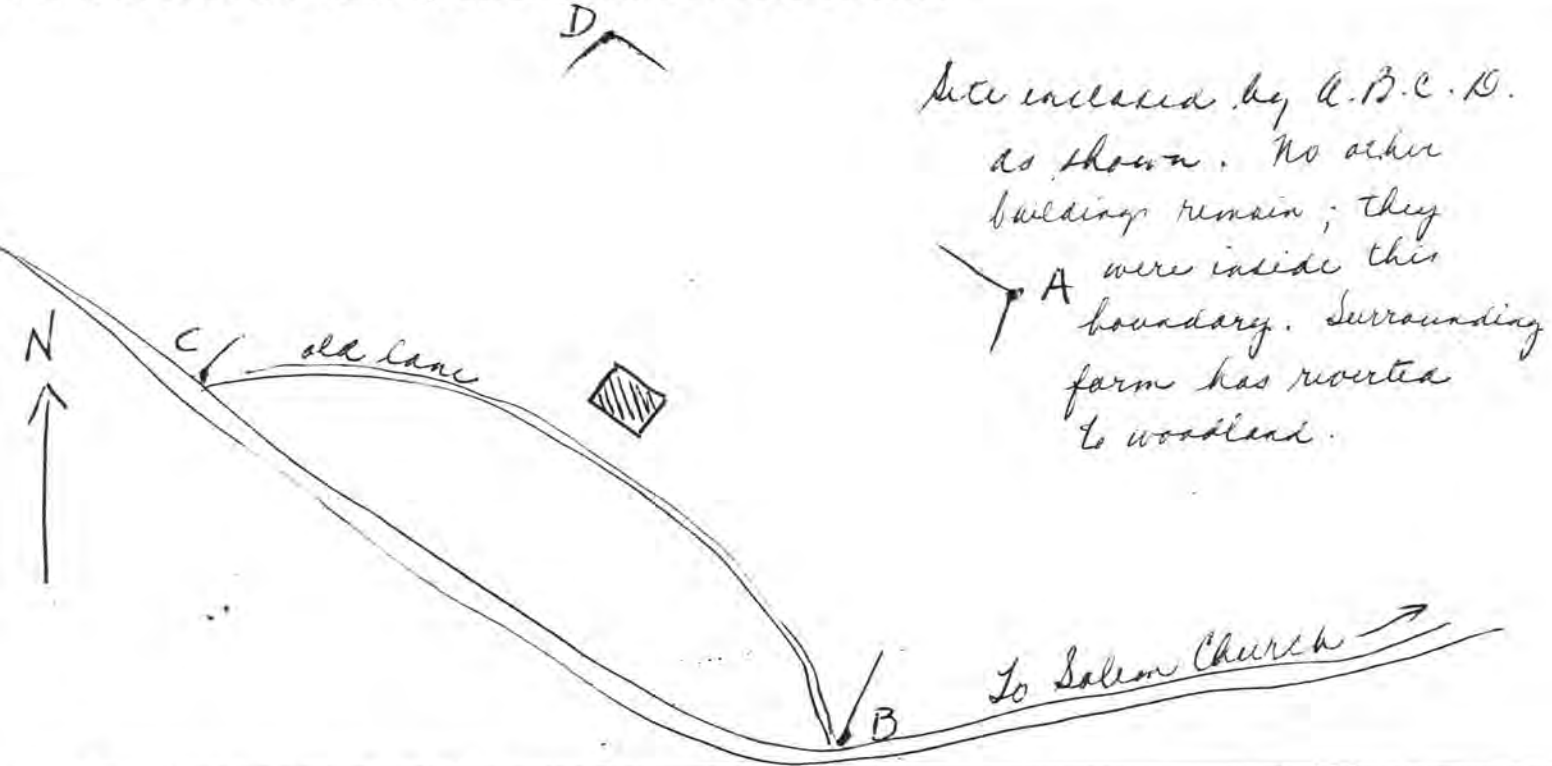

44. Description and House Plan:

Unique one-story, single cell, dry stone house with exterior gable end chimney. Full cellar with exterior entrance. House had wooden stoop on center of front, in front of the door which was the only opening in the front wall other than cellar. One window only in center of north wall, one window in center of west wall, and fireplace centered in east wall—common plan for primitive log house, but singular in stone. Part of one window frame remains, which has solid board reveal and ovolo trim.

Said by descendant to have had ladder-like stair to upstairs bedroom, which had small square windows (presumably in gable ends).

KENTUCKY HISTORIC RESOURCES INVENTORY

36. UTM Point of Primary Building: 17 753580 4264860 37. USGS Quadrant: Piqua 38. G.I.S. Mod. []
39. Coordinate Accuracy []

40. UTM Points of Boundary:
A. 17 753760 4264950 C. 17 753360 4264625 E. 17 753640 4265170
B. 17 753830 4265260 D. 17 753350 4265010 F. _____

41. Total Acreage in Present Property: 106 . 42. Acreage Included in Nominated Boundary: 45

43. Site Plan and Boundary Description and Justification:

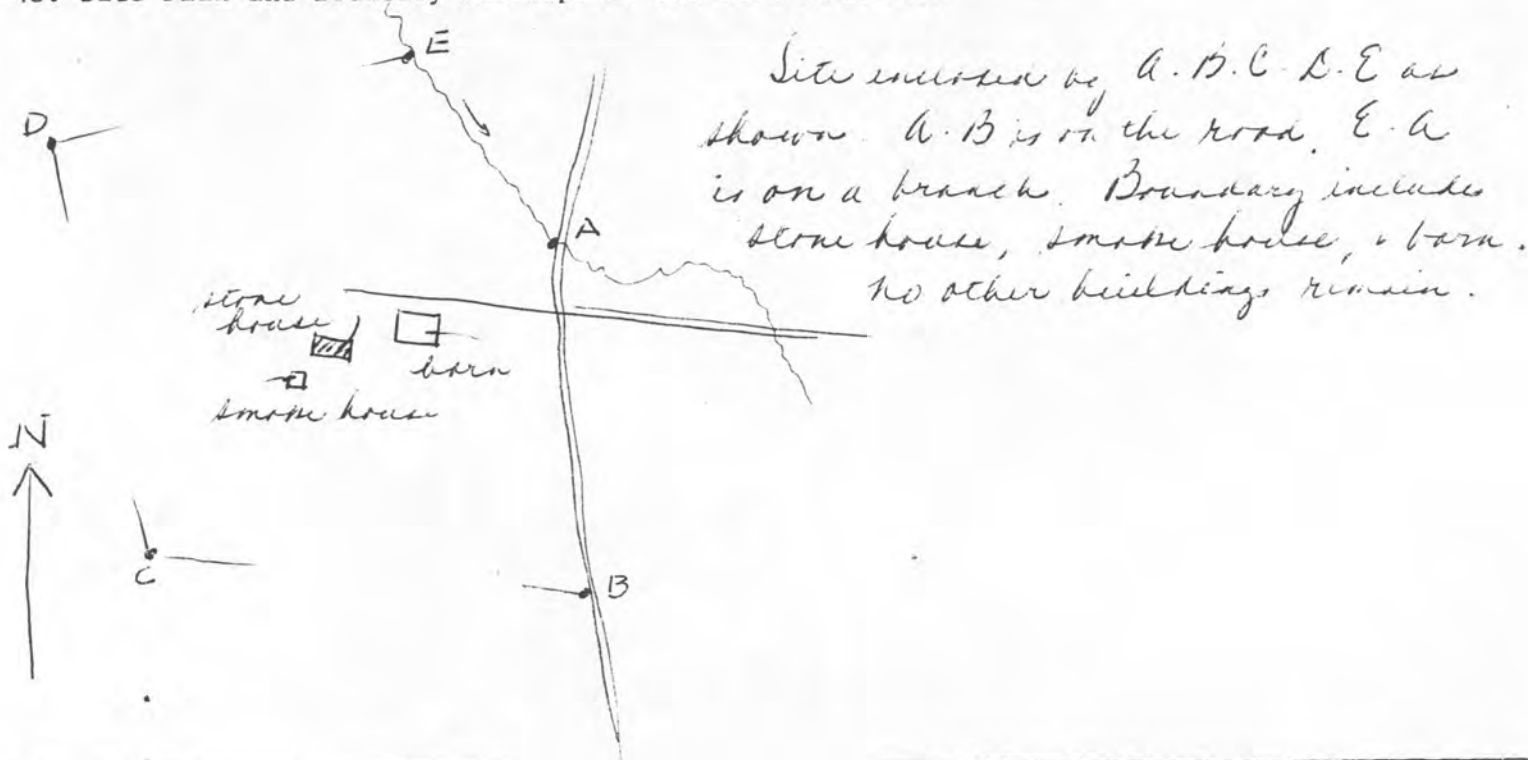

44. Description and House Plan:

One story, three bay, center passage, dry stone house, Upper Ordovician limestone of mixed color--some gray, some golden. Excellent quality masonry, well bonded, stones squared and coursed, original mortar steeple pointed (some concrete repointing). Exterior chimneys each gable end; square attic windows (now closed in). Exterior frames are covered with boards and front slope of roof has been raised to make more headroom upstairs.

House is of singular dimensions--ca. 20 X 50 ft; center passage is very wide--1/3 of house. All rooms have been sheathed with box car siding, but east room retains mantel and chair rail. Very fine mantel--5'2" tall X 6'10" wide, has fluting, dentils and pinwheel center block.

United States Department of the Interior
National Park Service

National Register of Historic Places
Inventory—Nomination Form

For NPS use only
received 8/6/85
date entered

Continuation sheet

Item number

Page 527

Multiple Resource Area
Thematic Group

Name Early Stone Buildings of Kentucky Thematic Resources
State Barren County and others, KENTUCKY

Nomination/Type of Review

Date/Signature

- | | | | | |
|----------------|---|-------------------------------|-------------------|---------------------------------|
| 41. | Doe Run Mill | Substantive Review | Keeper | <u>Amy Schlager 10/6/87</u> |
| | | | Attest | |
| 42. | Fullenwielder, Peter,
House | Substantive Review | Keeper | A Schlager 1/8/87 |
| | | | Attest | |
| 43. | Gray, John, Springhouse | Substantive Review | Keeper | A Schlager 1/8/87 |
| | | | Attest | |
| 44. | Henderson, Isham, House | Substantive Review | Keeper | A Schlager 1/8/87 |
| | | | Attest | |
| 45. | Hunter, Jacob, House | Substantive Review | Keeper | A Schlager 1/8/87 |
| | | | Attest | |
| 46. | Ice House on Little
Muddy Creek | Substantive Review | Keeper | A Schlager 1/8/87 |
| | | | Attest | |
| 47. | Gullian Gerigs's Mill
Killian Creek Mill | Substantive Review | Keeper | Amy Schlager 10/5/87 |
| | | | Attest | |
| 48. | Kirby, Jesse, Springhouse | Substantive Review | Keeper | A Schlager 4/8/87 |
| | | | Attest | |
| 49. | Kirkpatrick, Joseph,
House | Substantive Review | Keeper | |
| | | | Attest | |
| 50. | McCaughan, John, House | Substantive Review | Keeper | A Schlager 1/8/87 |
| | | | Attest | |

NATIONAL REGISTER OF HISTORIC PLACES
EVALUATION/RETURN SHEET

Hunter, Jacob, House (Early Stone Buildings of
Kentucky--Outer Bluegrass and Pennyrile TR)
Owen County
KENTUCKY

Substantive Review

Working No. 6/6/85
Fed. Reg. Date: 2/2/88
Date Due: 1/10/87
Action: ACCEPT 1-8-87
RETURN
REJECT

Federal Agency: _____

- resubmission
- nomination by person or local government
- owner objection
- appeal

Substantive Review: sample request appeal NR decision

Reviewer's comments:

*Cover form disc rare
nature of single cell
one big residential building*

Recom./Criteria Accept D
Reviewer Aschlagel
Discipline Arch Hist
Date 1/6/87
see continuation sheet

Nomination returned for: _____ technical corrections cited below *within context of stone bldgs*
_____ substantive reasons discussed below

1. Name

2. Location

3. Classification

Category	Ownership	Status	Present Use
	Public Acquisition	Accessible	

4. Owner of Property

5. Location of Legal Description

6. Representation in Existing Surveys

Has this property been determined eligible? yes no

7. Description

Condition		Check one	Check one
<input type="checkbox"/> excellent	<input type="checkbox"/> deteriorated	<input type="checkbox"/> unaltered	<input type="checkbox"/> original site
<input type="checkbox"/> good	<input type="checkbox"/> ruins	<input type="checkbox"/> altered	<input type="checkbox"/> moved date _____
<input type="checkbox"/> fair	<input type="checkbox"/> unexposed		

Describe the present and original (if known) physical appearance

- summary paragraph
- completeness
- clarity
- alterations/integrity
- dates
- boundary selection

8. Significance

Period _____ Areas of Significance—Check and justify below _____

Specific dates _____ Builder/Architect _____

Statement of Significance (*in one paragraph*) _____

- summary paragraph
- completeness
- clarity
- applicable criteria
- justification of areas checked
- relating significance to the resource
- context
- relationship of integrity to significance
- justification of exception
- other

9. Major Bibliographical References

10. Geographical Data

Acreage of nominated property _____

Quadrangle name _____

UTM References _____

Verbal boundary description and justification _____

11. Form Prepared By

12. State Historic Preservation Officer Certification

The evaluated significance of this property within the state is:

____ national ____ state ____ local

State Historic Preservation Officer signature _____

title _____ date _____

13. Other

- Maps
- Photographs
- Other

Questions concerning this nomination may be directed to _____

Signed _____ Date _____ Phone: _____







Jacob Hunter House (ON-19) Early
Stone Bldgs. of KY TR Nomination
UTM Ref: A. 16/677590/4219015
B. 16/677350/4269200
C. 16/677480/4269290
D. 16/677620/4267170

Mapped, edited, and published by the Geological Survey
Control by USGS and USC&GS
Topography from aerial photographs by multiplex methods
Aerial photographs taken 1949. Field check 1950
Polyconic projection. 1927 North American datum
10,000-foot grid based on Kentucky coordinate system,
north zone
1000-meter Universal Transverse Mercator grid ticks,
zone 16, shown in blue

UTM GRID AND 1950 MAGNETIC NORTH
DECLINATION AT CENTER OF SHEET



CONTOUR INTERVAL 20 FEET
DATUM IS MEAN SEA LEVEL

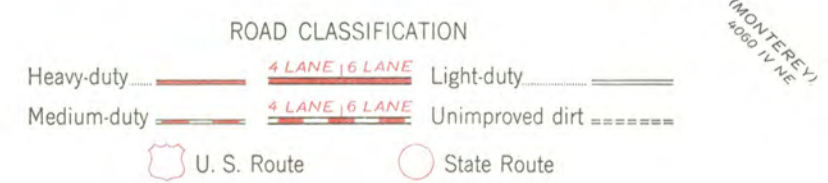

NEW LIBERTY, KY.
SW/4 OWENTON 15' QUADRANGLE
N3830-W8452.5/7.5

1950

AMS 4061 III SW-SERIES V853

THIS MAP COMPLIES WITH NATIONAL MAP ACCURACY STANDARDS
FOR SALE BY U. S. GEOLOGICAL SURVEY, WASHINGTON, D. C. 20242,
KENTUCKY GEOLOGICAL SURVEY, LEXINGTON, KENTUCKY 40506,
AND KENTUCKY DEPARTMENT OF COMMERCE, FRANKFORT, KENTUCKY 40601
A FOLDER DESCRIBING TOPOGRAPHIC MAPS AND SYMBOLS IS AVAILABLE ON REQUEST

JUN 6 1965