

KENTUCKY HISTORIC RESOURCES INVENTORY

(39)

ONO-12

Site No.

1. Historic Name(s) William Lindsey House

Original Owner William Lindsey

2. Present Name 220 W. Seminary Street

3. Location 220 W. Seminary Street

4. Owner's Name I.J. Goodrich

5. Owner's Address 220 W. Seminary, Owenton, Kentucky 40359

6. Open to Public Yes No

7. Ownership Private Local State Federal

28. ADD/County NKADD/Owen 094

29. U.S.G.S. Quadrant (15'/75') Owenton | | | G.I.S. Mod. | | |

30. UTM Reference 16 688340 4267340
Zone Easting Northing

31. Coordinate Accuracy | | |

32. Prehistoric Site Object
Historic Site Structure
Building Other

33. National Register District Name: | | |

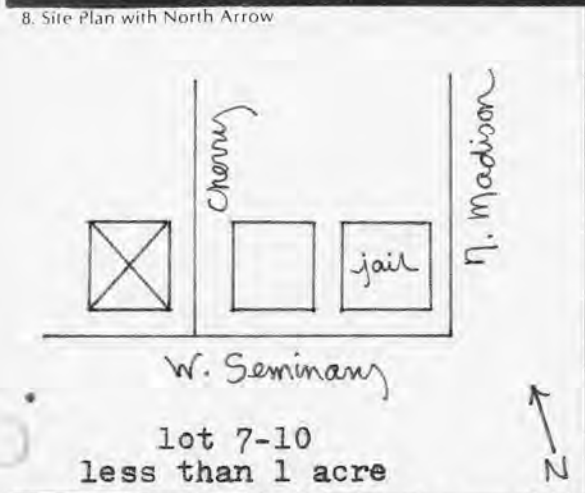

9. Architect/Builder _____

10. Date c. 1880 A. B.

11. Style A. eclectic B.

12. Original Use residence

13. Present Use residence

14. Condition good

15. Stories, No. of single story

34. Significance of Evaluation | | |

35. Status _____ Date _____

National Landmark	<input type="checkbox"/>
National Register	<input type="checkbox"/>
Landmark Certificate	<input type="checkbox"/>
Kentucky Survey	<input type="checkbox"/>
Local Landmark	<input type="checkbox"/>
HABS/HAER	<input type="checkbox"/>

36. Historic Theme architecture C

Primary architecture C

Secondary _____ | |

Other _____ | |

37. Endangered Yes No

16. Description Small Victorian, with decorative elements intact. 3-bay front has entry to right; door has transom. Windows are floor to ceiling 2/2 double-hung, with architrave trim. 2-bay raised porch has Ionic columns and lattice work. Small pointed-arch opening in front gable end. Small side porch to west has entrance door with transom. Cross-gable roof has modern asphalt shingles. Central brick chimney. Scalloped bargeboard present on all eaves. Frame addition at rear is one of many (over)
(Continue on Back)

17. Single Pile _____ NA _____

Double Pile

18. Floor Plan T-plan

19. Structural Fabric frame A. B.

20. Decorative Fabric clapboard A. B.

21. Roof Form & Material X-gable, asphalt shingle

22. Foundation Material quarried stone

23. Outbuildings

24. Alterations Additions
Moved Wall Treatment

38. ATTACH PHOTO

see photos 24 and 25

Roll No. 2

Picture No. 24 25

Direction from S, from NW

25. History William Lindsey owned the lot between 1878 and 1893. The house is present on the 1883 almanac map, and later Sanborn maps show the house with its 20th c. developments. Lindsey (over)

26. Significance Good example of late 19th century small eclectic residence. Best example of such a house in Owenton, with all decorative elements and architectural integrity intact.

27. Source of Information Owen County tax records; Betty Ligon; Pat Wolcott; T.A. Perry; 1883 almanac map; Sanborn maps

39. Prepared by: Lori A. Feldman

40. Organization P--NKADD

41. Date 12/83

42. Revision Dates _____ 43. Staff Review _____

16 continued: present over the years; Sanborn maps show a variety of small frame additions, all falling within the general dimensions of present one. Porch is not present on 1903 Sanborn map (shows two small side porches instead), but was added before 1925 (per Sanborn map), probably c. 1910.

25 continued: along with E.E. Settle established the Owenton Herald in 1893, an early newspaper.

See photo 24 and 25

101 A. Tolman

1-1-11
1/27

United States Department of the Interior
National Park Service

National Register of Historic Places
Inventory—Nomination Form

For NPS use only
received 7-25-84
date entered SEP 4 1984

Continuation sheet

Item number

Page 1 of 1

Multiple Resource Area
Thematic Group

dnr-11

Name Owenton Multiple Resource Area
State Owen County, KENTUCKY

Cover - ok - CD 9/4/84

Nomination/Type of Review

Date/Signature

1. Central Owenton Historic District

National Register

for Keeper Shelton Byers 9/4/84

Attest

2. North Main-North Adams
Historic District

Substantive Review

Keeper Carl Duke 9/4/84

Attest

3. Gibson House

DOE/OWNER OBJECTION
Substantive Review

Determined Eligible

Keeper Eligible - Carl Duke 9/4/84

Attest

4. Cox, L. O., House

Substantive Review

Keeper Carl Duke 9/4/84

Attest

5. Ford House

National Register

for Keeper Shelton Byers 9/4/84

Attest

6. Lindsey, William, House

National Register

for Keeper Shelton Byers 9/4/84

Attest

7. McKay House

National Register

for Keeper Shelton Byers 9/4/84

Attest

8. Settle, E. E., House

Included in the
National Register

for Keeper Shelton Byers 9/4/84

Attest

9.

Keeper

Attest

10.

Keeper

Attest

NATIONAL REGISTER OF HISTORIC PLACES
EVALUATION/RETURN SHEET

Lindsey, William, House (Owenton MRA)
Owen County
KENTUCKY

Working No. JUL 25 1984
Fed. Reg. Date: 2.5.86
Date Due: 8/23/84 - 9/8/84
Action: ACCEPT 9-4-84
 RETURN
 REJECT
Entered in the National Register Federal Agency: _____

- resubmission
- nomination by person or local government
- owner objection
- appeal

Substantive Review: sample request appeal NR decision

Reviewer's comments:

Recom./Criteria _____
Reviewer _____
Discipline _____
Date _____
_____ see continuation sheet

Nomination returned for: _____ technical corrections cited below
_____ substantive reasons discussed below

1. Name

2. Location

3. Classification

Category	Ownership Public Acquisition	Status Accessible	Present Use
----------	---------------------------------	----------------------	-------------

4. Owner of Property

5. Location of Legal Description

6. Representation in Existing Surveys

Has this property been determined eligible? yes no

7. Description

Condition		Check one	Check one
<input type="checkbox"/> excellent	<input type="checkbox"/> deteriorated	<input type="checkbox"/> unaltered	<input type="checkbox"/> original site
<input type="checkbox"/> good	<input type="checkbox"/> ruins	<input type="checkbox"/> altered	<input type="checkbox"/> moved date _____
<input type="checkbox"/> fair	<input type="checkbox"/> unexposed		

Describe the present and original (if known) physical appearance

- summary paragraph
- completeness
- clarity
- alterations/integrity
- dates
- boundary selection

8. Significance

Period Areas of Significance—Check and justify below

Specific dates Builder/Architect

Statement of Significance *(in one paragraph)*

- summary paragraph
- completeness
- clarity
- applicable criteria
- justification of areas checked
- relating significance to the resource
- context
- relationship of integrity to significance
- justification of exception
- other

9. Major Bibliographical References

10. Geographical Data

Acreage of nominated property _____

Quadrangle name _____

UTM References _____

Verbal boundary description and justification _____

11. Form Prepared By

12. State Historic Preservation Officer Certification

The evaluated significance of this property within the state is:

____ national ____ state ____ local

State Historic Preservation Officer signature _____

title date

13. Other

- Maps
- Photographs
- Other

Questions concerning this nomination may be directed to _____

Signed _____ Date _____ Phone: _____





Please refer to the map in the
Multiple Property Cover Sheet
for this property

Multiple Property Cover Sheet Reference Number: 64000248