

H.S.



Post Office Department,

OFFICE OF THE FIRST ASSISTANT P. M. GENERAL,

Appointment Division,

WASHINGTON, D. C., Aug 21, 1891

SIR: Before the Postmaster General decides upon the application for the establishment of a post office at Hume, County of Boone, State of W. Va., it will be necessary for you to carefully answer the subjoined questions, get a neighboring postmaster to certify to the correctness of the answers, and return the location paper to the Department, addressed to me. If the site selected for the proposed office should not be on any mail route now under contract, only a "Special Office" can be established there, to be supplied with mail from some convenient point on the nearest mail route by a special carrier (see section 733, Postal Laws and Regulations of 1887), for which service a sum equal to two-thirds of the amount of the salary of the postmaster at such office will be paid by the Department.

You should inform the contractor, or person performing service for him, of this application, and require him to execute the inclosed certificate as to the practicability of supplying the proposed office with mail, and return the same to the Department.

Very respectfully,

W. G. Ragsdale
Alpha field

First Asst. Postmaster General.

To Mr. J. S. Hume
 care of the Postmaster of Verona, who will please forward to him.

STATEMENT.

The proposed office to be called

Hume Store

Select a short name for the proposed office, which, when written, will not resemble the name of any other post office in the State.

It will be situated in the _____ quarter of Section _____, Township _____ (North or South), Range _____ (East or West), _____ in the County of Boone, State of West Virginia.
 It will be on or near route No. 243, being the route from Verona East to North, on which the mail is now carried _____ times per week.
 Will it be directly on this route? Yes
 If not, how far from it?—1/2 miles.
 If not on any route, is a "Special Office" wanted?—Yes. To be supplied from Verona.
 The name of the nearest office to the proposed one, on one side, is Verona.
 Its distance is 1/2 miles _____ miles in a South West direction from the proposed office.
 The name of the nearest office, on the other side, is Beavers.
 Its distance is 3/4 miles _____ miles in a South East direction from the proposed office.
 The name of the other nearest office to the proposed one is Verona.
 Its distance by the most direct road is 1/4 miles _____ miles in a South East direction from the proposed office.
 The name of the most prominent river near it is Big Ohio River.
 The name of the nearest creek is Hand Creek.
 The proposed office will be _____ miles from said river, on the East side of it, and will be _____ miles from said _____ on the South side of it.
 The name of the nearest railroad is W. Va. Street Car.
 If on the line of or near a railroad, on which side will the office be located; how far from the track; and what is, or will be, the name of the station?—Verona.
 If it be a village, state the number of inhabitants—100.
 Also, the population to be supplied by the proposed office—100.
 A diagram, or sketch from a map, showing the position of the proposed new office, with neighboring river or creek, roads, and other post offices, towns, or villages near it, will be useful, and is therefore desired.

A correct map of the locality might be furnished by the county surveyor, but this must be without expense to the Post Office Department.

ALL WHICH I CERTIFY to be correct and true, according to the best of my knowledge and belief, this 25th day of August, 1891.

(Sign full name.) John Peter Kousis Proposed P. M.

I CERTIFY that I have examined the foregoing statement, and that it is correct and true, to the best of my knowledge and belief.

C. C. Stout
 Postmaster at Verona



Dickerson
Verona
W. Va.

(OVER.)

BE CAREFUL TO ANSWER THE INQUIRIES FULLY AND ACCURATELY, OR THE CASE WILL NOT BE ACTED UPON.

Applications for post offices should be accompanied by petitions of the citizens interested.

Diagram showing the site of the Hume Post Office,
 in Township _____ (N. or S.), Range _____ (E. or W.) of _____
 Meridian, County of Boone Principal State _____
 of Kentucky with the adjacent Townships and Post Offices.

It is requested that the exact site of the proposed or existing Post Office, as also the roads to the adjoining offices, and the larger streams or rivers, be marked on this diagram, to be returned as soon as possible to the Post Office Department.

(North.)

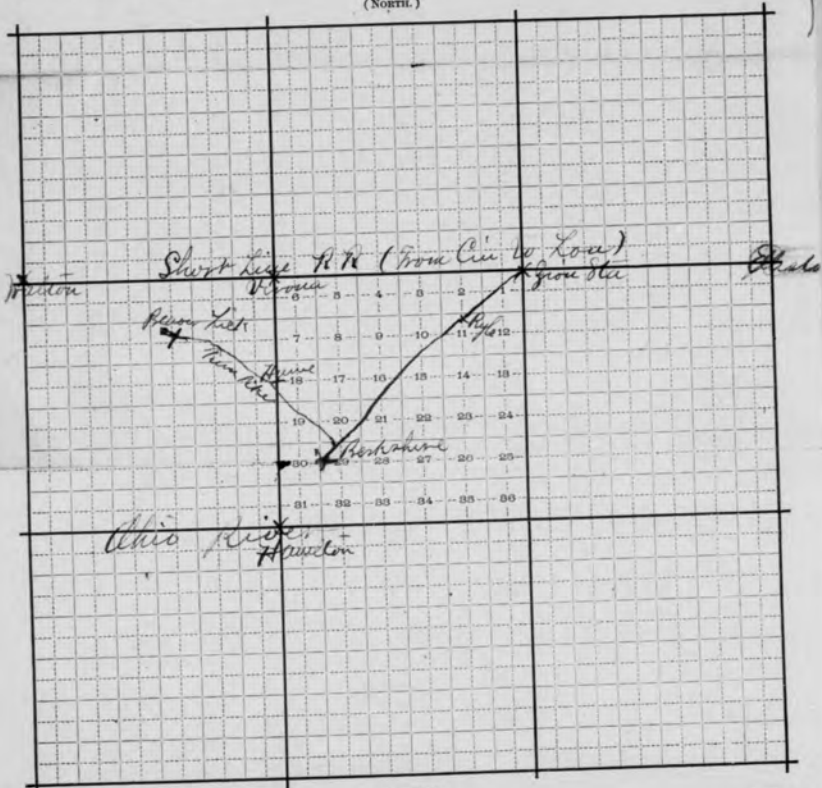

Scale 1/2 inch to the mile.

(South.)

5-302

Post Office Department,

OFFICE OF THE FOURTH ASSISTANT POSTMASTER GENERAL,
APPOINTMENT DIVISION,

WASHINGTON, D. C., Oct 9, 189 9

SIR: Before the Postmaster General decides upon the application for the establishment of a post office at Hume Store, County of Boone, State of Ky, it will be necessary for you to carefully answer the subjoined questions, get a neighboring postmaster to certify to the correctness of the answers, and return the location paper to the Department, addressed to me. If the site selected for the proposed office should not be on any mail route now under contract, only a "Special Office" can be established there, to be supplied with mail from some convenient point on the nearest mail route by a special carrier (see section 702, Postal Laws and Regulations of 1893), for which service a sum equal to two-thirds of the amount of the salary of the postmaster at such office will be paid by the Department.

You should inform the contractor, or person performing service for him, of this application, and require him to execute the inclosed certificate as to the practicability of supplying the proposed office with mail, and return the same to the Department.

Very respectfully,

J. P. Bristow

Fourth Assistant Postmaster General.

To Mr. Carroll Hilliard

care of the Postmaster of Verona, who will please forward to him.

STATEMENT.

The proposed office to be called

Hume Store

Select a short name for the proposed office, which, when written, will not resemble the name of any other post office in the State.

It will be situated in the quarter of Section Township (North or South),
Range (East or West) in the County of Boone, State of Kentucky
It will be on or near route No. 2937, being the route from Verona to Hume Store, on which the mail is now carried times per week.
Will it be directly on this route?—Yes.
If not, how far from it?—Two miles.
If not on any route, is a "Special Office" wanted?—Yes. To be supplied from Verona.
The name of the nearest office to the proposed one, on one side, is Verona, its distance is 2 miles in a South West direction from the proposed office.
The name of the nearest office, on the other side, is Verona, its distance is 2 miles in a North East direction from the proposed office.
The name of the other nearest office to the proposed one is Verona, its distance by the most direct road is 4 miles in a North West direction from the proposed office.
The name of the most prominent river near it is Gaspe.
The name of the nearest creek is Mardick.
The proposed office will be miles from said river, on the East side of it, and will be Eight miles from said nearest creek, on the South side of it.
The name of the nearest railroad is Verona to Nashville (Great Line).
If on the line of or near a railroad, on which side will the office be located; how far from the track; and what is, or will be, the name of the station?—Verona.
Give the population to be supplied by the proposed office.—140.
If it be a village, state the number of inhabitants.—35.
A diagram, or sketch from a map, showing the position of the proposed new office, with neighboring river or creek, roads and other post offices, towns, or villages near it, will be useful, and is therefore desired.

A correct map of the locality might be furnished by the county surveyor, but this must be without expense to the Post Office Department.

ALL WHICH I CERTIFY to be correct and true, according to the best of my knowledge and belief, this 16th day of October, 189 9.

(Sign full name.) Carroll Hilliard Proposed P. M.

I CERTIFY that I have examined the foregoing statement, and that it is correct and true, to the best of my knowledge and belief. (This must be signed by Postmaster at nearest office.)

W. H. H. H. H.
Postmaster at Verona

(OVER.)

Applications for post offices should be accompanied by petitions of the citizens interested.

DIAGRAM, EXPLANATION, AND INSTRUCTIONS.

The dot in the center of the 1-mile circle represents the site of the post office.
 The surrounding offices should be carefully located by placing dots on or between the mile circles at the exact distance, and in the right direction, from the post office, and their names plainly written.
 Draw distinctly the railways, roads, rivers, and creeks.

5-5225

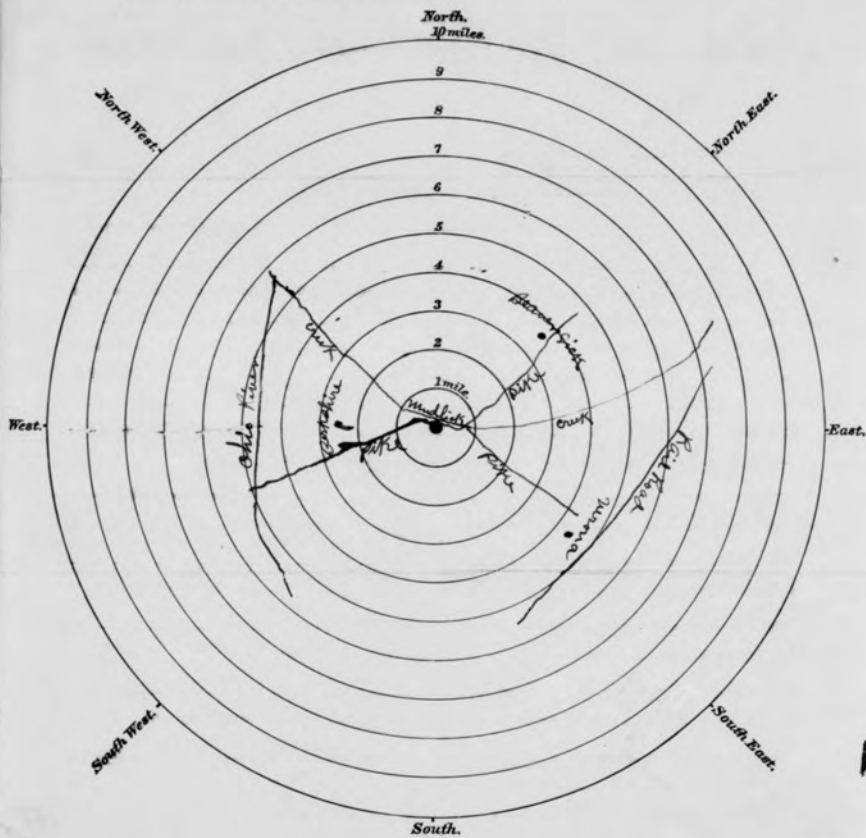

201

H

Division of Supplies
DIVISION OF TOPOGRAPHY



Post Office Department
FOURTH ASSISTANT POSTMASTER GENERAL
Washington, Dec 27, 1913.

SIR: In order that the site of your post office may be accurately represented upon the post-route maps, it is requested that you carefully answer the questions below and furnish a sketch, according to instructions on opposite side of paper, which should be returned to this Division as soon as possible. Respectfully,

To Postmaster at Hume
Boone Co.,
Ky.

John C. Parsley
Fourth Assistant Postmaster General.

The name of my post office is Hume

If the town, village, or site of the post office be known by another name than that of the post office, state that other name here: _____

My post office is situated in the _____ part of _____ Township,
or in _____ quarter of tract _____ Number _____ Township,

County of Boone State of Kentucky

The name of the nearest river is the Ohio, and the post-office building is at a distance of Four Miles on the E side of it.
N., S., E., or W.

The name of the nearest creek is Mudlick, and the post-office building is at a distance of 1/8 Mile on the W side of it.
N., S., E., or W.

The name of the nearest office on my route is Berkshire
and its distance is 2 1/2 miles, by the traveled road, in a W direction from this, my office.
N., S., E., or W.

The name of the nearest office on my route, on the other side, is Verona
and its distance is 4 1/4 miles, in a S. E. direction from this, my office.
N., S., E., or W.

The name of the nearest office not on my route is Beaver Slick
and its distance is 3 1/2 miles, by the traveled road, in a N. E. direction from this, my office.
N., S., E., or W.

The post-office building is on the N. W. side of the Somerville + Nashville Railroad,
and at a distance of 4 1/4 from the track.
N., S., E., or W.

The railroad station name is Verona

My post office is 1 1/2 Miles, air-line distance, 1 from the nearest point of my county boundary.
N., S., E., or W.

Postmaster: Jerry M. Jackson
Date: Jan 6 1914