



1004.)

Post Office Department,

OFFICE OF THE FIRST ASSISTANT P. M. GENERAL,

WASHINGTON, D. C., _____, 188 .

SIR: Before the Postmaster General decides upon the application for a new post office at _____, County of _____, State of _____

at which you are recommended for postmaster, he requires that the blanks in the following statement be filled, and the questions carefully and correctly answered, verified by your signature, certified by a neighboring postmaster, and returned to this Department, addressed to me. The contractor should be informed of this application; and if the site of the proposed office be off the mail route, you will forward his certificate as to the practicability of supplying it, and also as to the increase of distance. If the proposed office is not on any route now under contract, it can only be established as a "Special Office," to be supplied without expense to the Department other than net proceeds.

Be careful to designate the post offices by their true official names; and answer the subjoined queries fully and accurately, or the case will not be acted upon.

Very respectfully,

JAMES N. TYNER,
First Assistant Postmaster General.

To Mr. _____
care of the Postmaster of _____, who will please forward to him.

STATEMENT.

The proposed office to be called

Parina

Select a short name for the proposed office, which, when written, will not resemble the name of any other post office in the United States.

It will be situated on the _____ quarter of Section _____ Township _____ Range _____, in the County of Brookston, State of Ohio

It will be on or near route No. _____ being the route from _____ to _____, on which the mail is now carried _____ times per week.

The contractor's name is _____

Will it be directly on this route?—Ans. _____

If not, how far from, and on which side of it?—Ans. _____

How much will it INCREASE the travel of the mail one way each trip?—Ans. _____

Where will the mail leave the present route to supply the proposed office?—Ans. _____

Where intersect the route again?—Ans. _____

What post office will be left out by this change?—Ans. _____

If not on any route, is a "Special Office" wanted?—Ans. Yes. To be supplied from Brooksville

The name of the nearest office to the proposed one, on the same route, is _____

its distance is _____ miles, in a _____ direction from the proposed office.

The name of the nearest office on the same route, on the other side, is _____

its distance is _____ miles, in a _____ direction from the proposed office.

The name of the nearest office to the proposed one, not on this route, is Brooksville distance by the most direct road 4 1/2 miles, in a N. West direction from the proposed office.

The name of the most prominent river near it is The Ohio

The name of the nearest creek is Camp Creek

The proposed office will be 1 1/2 miles from said river, on the South side of it, and will be 1/2 miles from said nearest creek, on the N. West side of it.

If near a railroad, state of which side the office will be located, how far from, and the name of the station or depot.—Ans. _____

If it be a village, state the number of inhabitants.—Ans. _____

Also, the population to be supplied by proposed office.—Ans. We cannot give the population but it is a large & thickly settled neighborhood.

A diagram, or sketch from a map, showing the position of the proposed new office, with neighboring river or creek, roads and other post offices, towns, or villages near it, will be useful, and is therefore desired.

A correct map of the locality might be furnished by the county surveyor, but this must be without expense to the Post Office Department.

ALL WHICH I CERTIFY to be correct and true, according to the best of my knowledge and belief, this 21st

day of July, 1880

Albert H. McBeth, Proposed P. M.

I CERTIFY that I have examined the foregoing statement, and that it is correct and true, to the best of my knowledge and belief.

George S. Staton
Postmaster at Brooksville

(OVER.)



Form
Post Office
1877

Diagram showing the site of the Proposed Post Office
in Township _____, Range _____ of _____ Principal
Meridian, County of Boeckw, State
of Kentucky, with the adjacent Townships and Post Offices.

It is requested that the exact site of the proposed, or existing Post Office, as also the roads to the adjoining offices, and the larger streams or rivers, be marked on this diagram, to be returned as soon as possible to the Post Office Department.

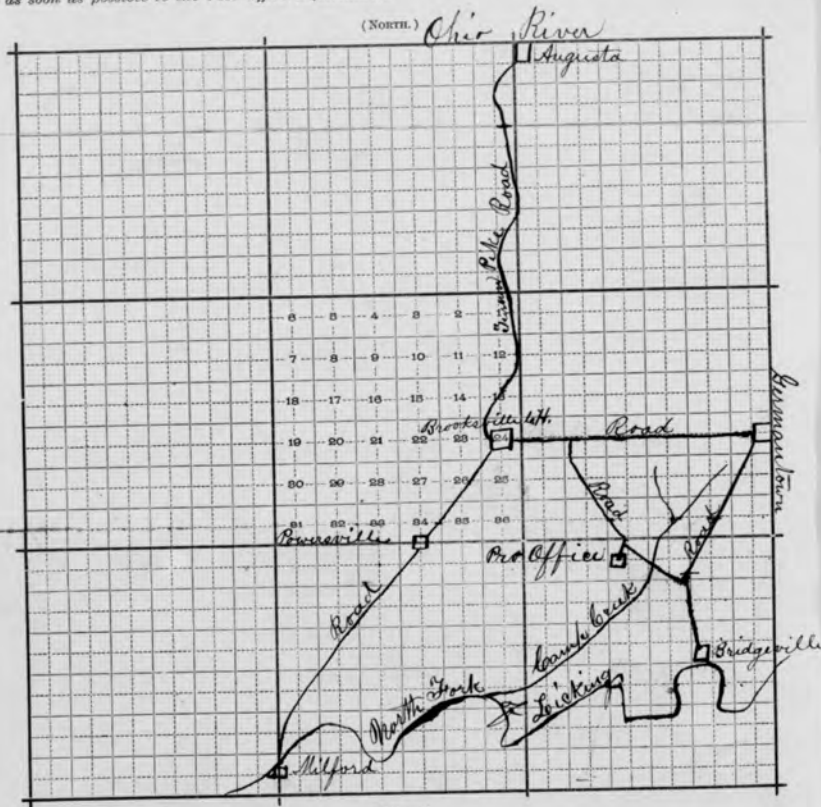

Post Office Department,

OFFICE OF THE FOURTH ASSISTANT POSTMASTER GENERAL,

APPOINTMENT DIVISION.

WASHINGTON, D. C., May 1, 1893

Sir: Before the Postmaster General decides upon the application for the establishment of a post office at Parina, County of Boonville, State of Kentucky, it will be necessary for you to carefully answer the subjoined questions, get a neighboring postmaster to certify to the correctness of the answers, and return the location paper to the Department, addressed to me. If the site selected for the proposed office should not be on any mail route now under contract, only a "Special Office" can be established there, to be supplied with mail from some convenient point on the nearest mail route by a special carrier (see section 733, Postal Laws and Regulations of 1887), for which service a sum equal to two-thirds of the amount of the salary of the postmaster at such office will be paid by the Department.

You should inform the contractor, or person performing service for him, of this application, and require him to execute the inclosed certificate as to the practicability of supplying the proposed office with mail, and return the same to the Department.

Very respectfully,

E. G. Rachbone
Fourth Asst Postmaster General.

To Mr. Wm Huffmancare of the Postmaster of Brooksville, who will please forward to him.

STATEMENT.

The proposed office to be called

Parina

Select a short name for the proposed office, which, when written, will not resemble the name of any other post office in the State.

It will be situated in the quarter of Section Township (North or South)
 Range (East or West) in the County of Boonville, State of Kentucky.
 It will be on or near route No., being the route from
 to on which the mail is now carried times per week.
 Will it be directly on this route?—Ans.
 If not, how far from it?—Ans. To be supplied from Brooksville.
 If not on any route, is a "Special Office" wanted?—Ans. Yes.
 The name of the nearest office to the proposed one, on one side, is Brooksville.
 Its distance is 7 1/2 miles in a Northwest direction from the proposed office.
 The name of the nearest office, on the other side, is Brooksville.
 Its distance is 8 miles in a Southwest direction from the proposed office.
 The name of the other nearest office to the proposed one is Brooksville.
 Its distance by the most direct road is 8 miles in a Southwest direction from the proposed office.
 The name of the most prominent river near it is Barren River.
 The name of the nearest creek is Barren Creek.
 The proposed office will be 12 miles from said river, on the South side of it, and will be 3 1/2 miles from said nearest creek, on the West side of it.
 The name of the nearest railroad is Chickasaw.
 If on the line of or near a railroad, on which side will the office be located; how far from the track; and what is, or will be, the name of the station?—Ans.
 If it be a village, state the number of inhabitants.—Ans. Two Hundred.
 Also, the population to be supplied by the proposed office.—Ans. Two Hundred.
 A diagram, or sketch from a map, showing the position of the proposed new office, with neighboring river or creek, roads, and other post offices, towns, or villages near it, will be useful, and is therefore desired.
 A correct map of the locality might be furnished by the county surveyor, but this must be without expense to the Post Office Department.

ALL WHICH I CERTIFY to be correct and true, according to the best of my knowledge and belief, this Fourth day of May, 1893

(P Sign full name.) Wm Huffman Proposed P. M.
 I CERTIFY that I have examined the foregoing statement, and that it is correct and true, to the best of my knowledge and belief.

William WilliamsPostmaster at BrooksvilleWm Huffman

(OVER.)

Be careful to answer the queries fully and accurately, or the case will not be acted upon.

Applications for post offices should be accompanied by petitions of the citizens interested.

Summer

Channah, N.Y.

Diagram showing the site of the _____ Post Office,
 in Township _____ (N. or S.), Range _____ (E. or W.) of _____ Principal
 Meridian, County of _____, State
 of _____, with the adjacent Townships and Post-Offices.

It is requested that the exact site of the proposed or existing Post Office, as well as the roads, the
 adjoining offices, and the larger streams or rivers, be marked on this diagram, to be returned as soon
 as possible to the Post Office Department.

(North.)

OHIO

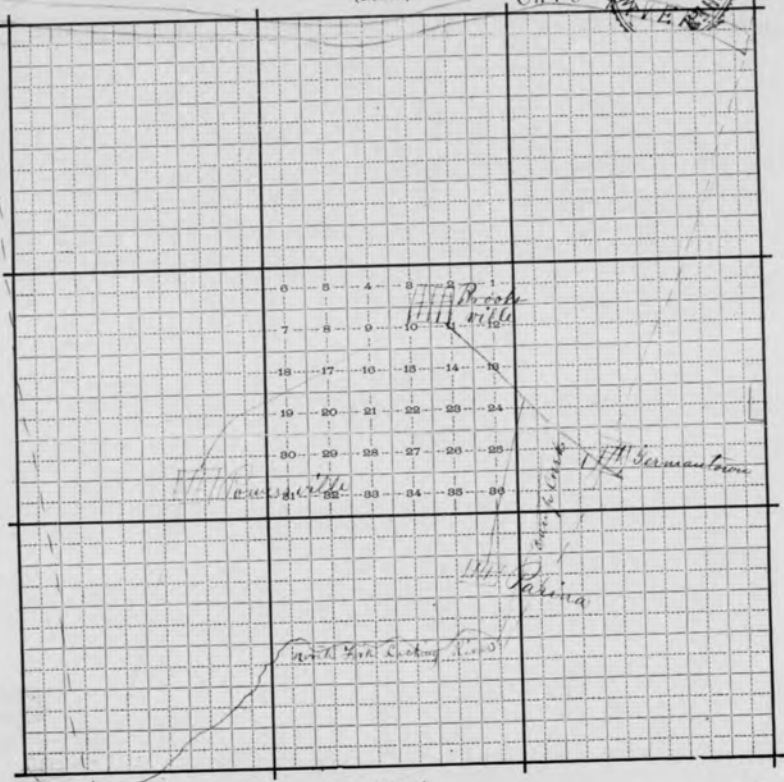
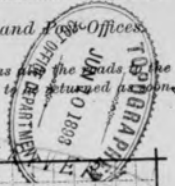

Scale 1 inch to the mile.

(South.)